

ITEM	DESCRIPTION	ITEM MASS	QTY.	MASS
1	LEG 1 - FRONT FACE - 3mm - FRONT	0.25	1	0.25
2	LEG 1 - FRONT FACE - 3mm - ANKLE	0.06	3	0.18
3	LEG 1 - FRONT FACE - 3mm - SMALL ANKLE	0.03	1	0.03
4	LEG 1 - FRONT FACE - 3mm - BACK	0.26	1	0.26
5	LEG 1 - FRONT FACE - 3mm - ANKLE BACK WITH HOLE	0.02	3	0.06
6	LEG 1 - FRONT FACE - 3mm - ANKLE BACK	0.06	1	0.06
7	LEG 1 - RIB - 3mm	0.00	6	0.00
8	LEG 1 - RIB - 3mm - TOP	0.00	2	0.00
9	LEG 1 - SIDE - 3mm	0.06	1	0.06
10	LEG 1 - SIDE - 3mm	0.06	1	0.06
11	LEG 1 - MAIN SHOULDER RIB - 3mm	0.01	6	0.06
12	LEG 1 - SHOULDER SIDE - 3mm	0.01	2	0.02
13	LEG 1 - DETAIL BACK	0.01	2	0.02
14	LEG 1 - DETAIL FRONT	0.00	2	0.00
15	LEG 1 - DETAIL SIDE	0.00	2	0.00
16	LEG 1 - CENTRE RIB - 3mm	0.05	2	0.10
17	LEG 1 - SHOULDER HUB - 3mm - HUB	0.06	2	0.12
18	LEG 1 - SHOULDER HUB - 3mm - SHOULDER	0.06	1	0.06
19	LEG 1 - SHOULDER HUB - 3mm - COVER	0.06	1	0.06
20	LEG 1 - SHOULDER RIB - 3mm	0.01	12	0.12
21	LEG 1 - SHOULDER SIDE RIB - 3mm	0.00	2	0.00
22	LEG 1 - FRONT FACE - 3mm - CABLE RUN	0.02	3	0.06
23	ANKLE STUFF			0.00
24	LEG 1 - ANKLE BB SPACER	0.00	2	0.00
25	LEG 1 - ANKLE SIDE	0.03	2	0.06
26	LEG 1 - ANKLE SIDE SLOPE	0.00	2	0.00
27	LEG 1 - ANKLE TOP	0.00	1	0.00
28	LEG 1 - ANKLE BOTTOM	0.01	1	0.01
29	LEG 1 - ANKLE DETAIL	0.01	1	0.01
30	LEG 1 - ANKLE DETAIL BASE	0.03	1	0.03
31	LEG 1 - ANKLE DETAIL RIB	0.01	1	0.01
32	LEG 1 - ANKLE DETAIL WEB	0.01	1	0.01
33	LEG 1 - ANKLE FACE	0.02	1	0.02
34	LEG 1 - ANKLE DETAIL FACE	0.02	1	0.02
35	LEG 1 - ANKLE BRACLET	0.02	1	0.02
36	LEG 1 - ANKLE CABLE GUIDE SLOPE	0.01	1	0.01
37	SKINS		73	0.00
38	LEG 1 - ANKLE BOTTOM CURVE SKIN - 1mm	0.01	1	0.01
39	LEG 1 - ANKLE SIDE - 1mm	0.01	2	0.02
40	LEG 1 - ANKLE FRONT SKIN - 1mm	0.01	1	0.01
41	LEG 1 - ANKLE BOTTOM - 1mm	0.00	1	0.00
42	LEG 1 - ANKLE - 1mm	0.01	1	0.01
43	LEG 1 - SHOULDER DETAIL FILL - 1mm	0.00	4	0.00
44	LEG 1 - SHOULDER DETAIL FACE - 1mm	0.00	2	0.00
45	LEG 1 - SHOULDER CURVE - 1mm	0.02	1	0.02
46	LEG 1 - SHOULDER OUTER CURVE - 1mm	0.05	1	0.05
47	LEG 1 - LEG FACE - 1mm	0.06	1	0.06
48	LEG 1 - LEG FACE - 1mm	0.05	1	0.05
49	LEG 1 - SHOULDER HUB OUTER - 1mm	0.05	1	0.05
50	LEG 1 - LEG SIDE - 1mm	0.01	2	0.02
51	LEG 1 - LEG SIDE - 1mm	0.01	2	0.02
52	FASTENERS			0.00
53	M6 PLAIN WASHER 304	0.00	17	0.00
54	Hex Head Set Screw M6 x 75	0.02	4	0.08
55	Hex Nut Plain M6	2.56	8	20.48
56	Wing Nut M6	0.01	5	0.05
57	Socket Head Cap Screw M6 x 35	0.01	1	0.01
58	TOTAL			22.72

!! NOTE !!
1off AS DRAWN (RH LEG)
1off OPPOSITE HAND (LH LEG)
(ONLY CHANGE, LOCATION OF CABLE BACK HOLE)

IT IS ADVISED TO CUT 1mm PARTS OVERSIZED AND TRIM BACK AFTER GLUE HAS SET

These instructions are only a guide.
 There are many version of "R2" style units
 Builder ultimately responsible for there build

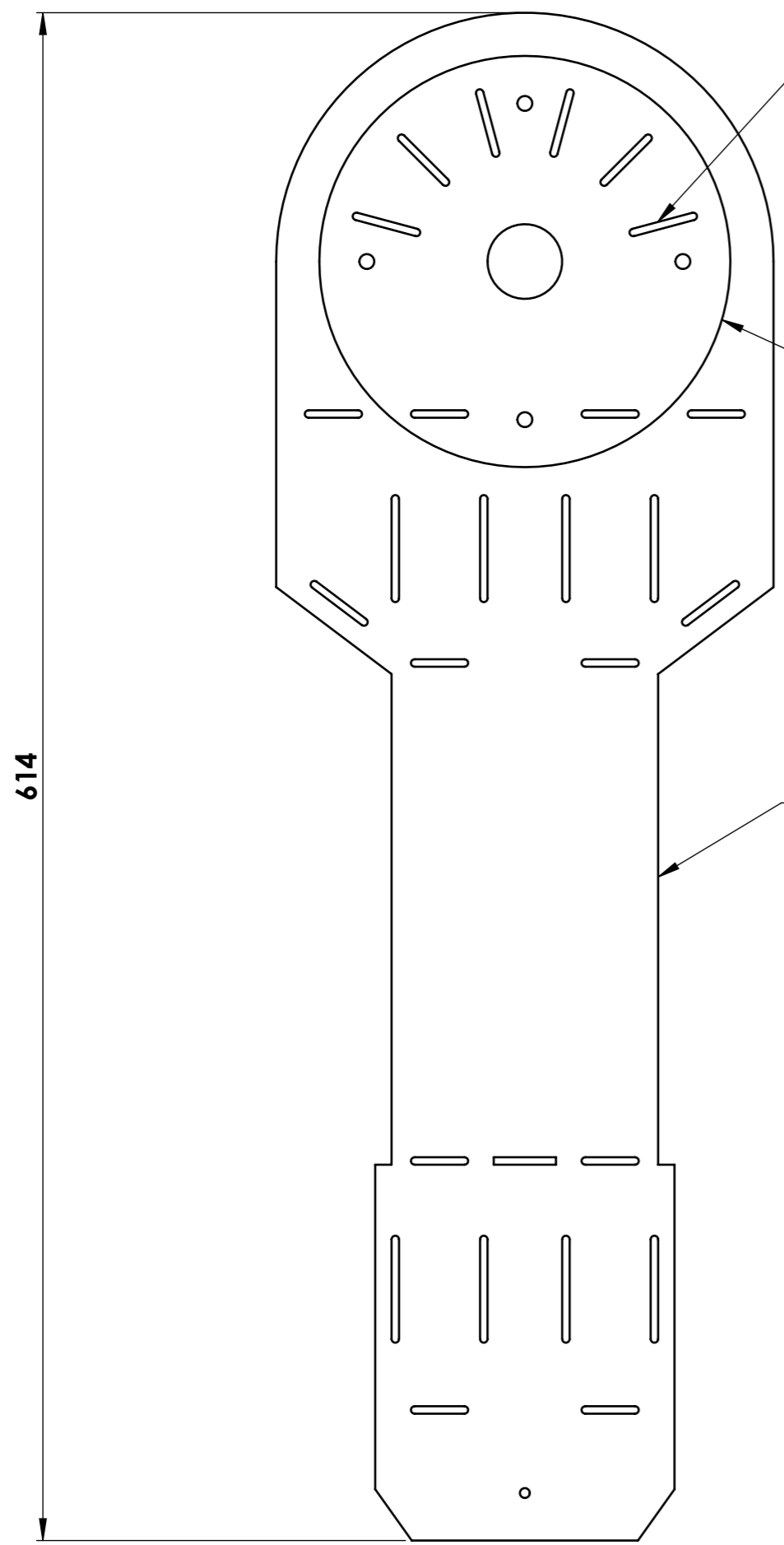

ENSURE ALL HOLES ARE ALIGNED ACCURATLY AND DRESS/FILE AS REQUIRED

ENSURE JOIN IS THOROUGHLY GLUED INTO POSITION

STEPS 1 TO 8
!! MAKE SURE IT IS MADE ON A FLAT SURFACE !!!
YOU CAN SCREW TO A PIECE OF MDF THROUGH HOLES MARKED

!! CAUTION !! BE CAREFULL YOU DONT GLUE LEG TO THE MDF (DO NOT LEAVE OVERNIGHT)

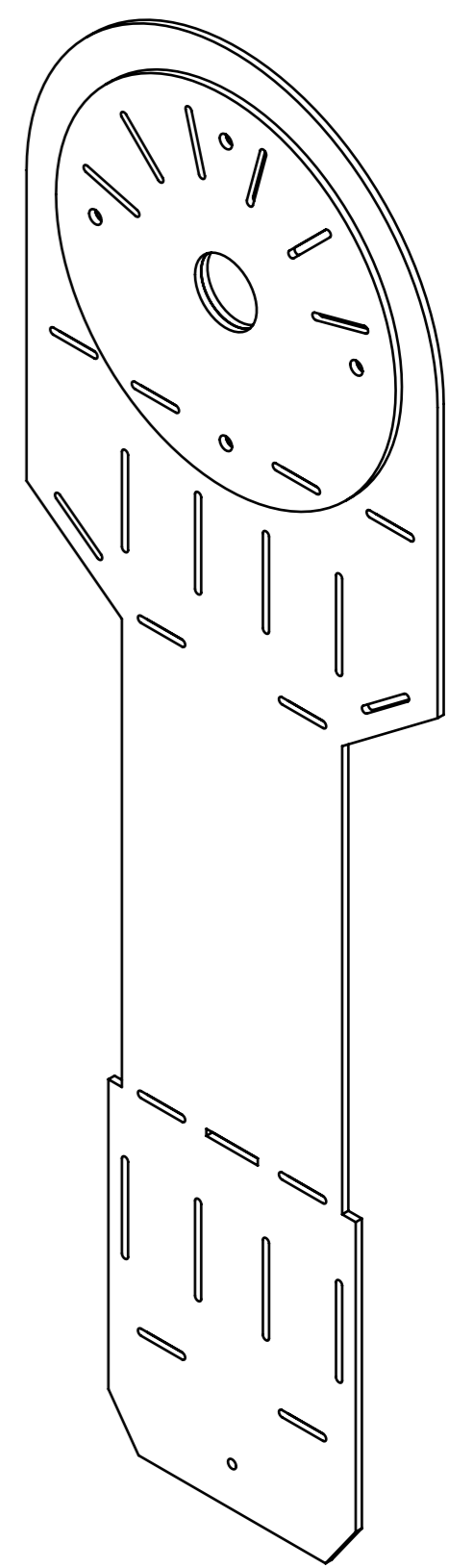
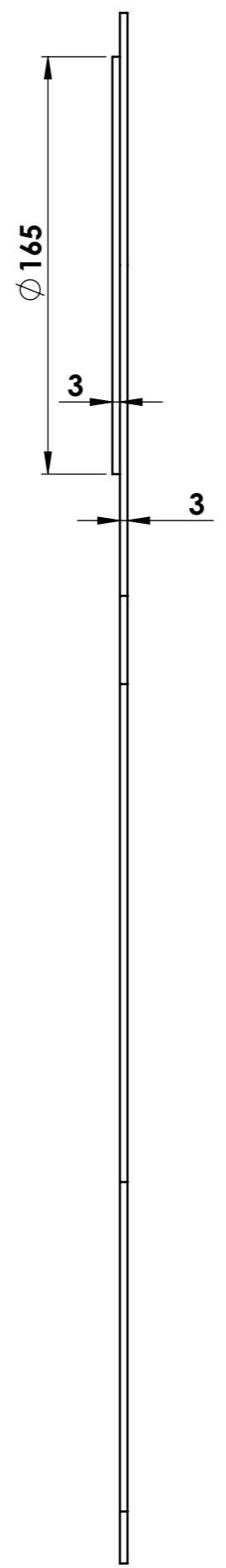

STEP 1

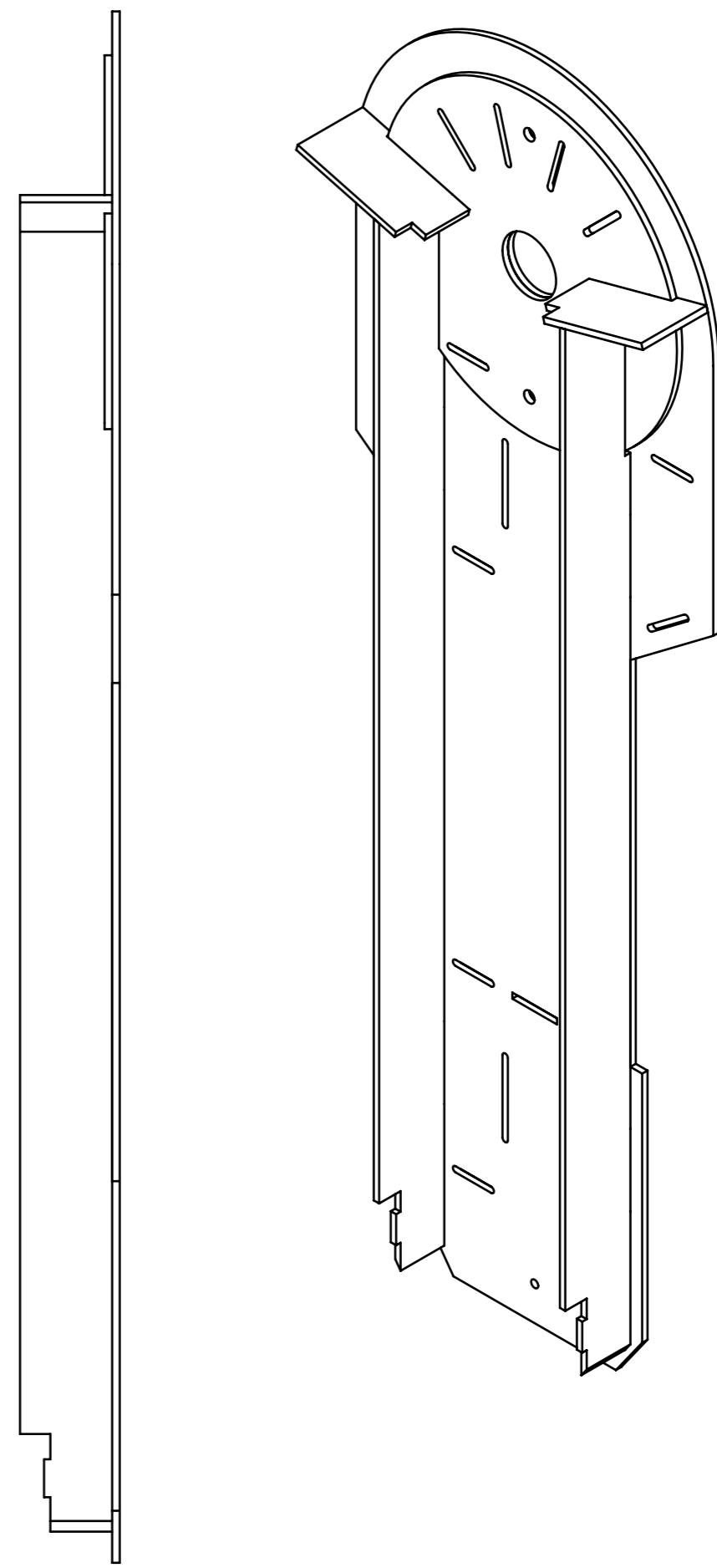
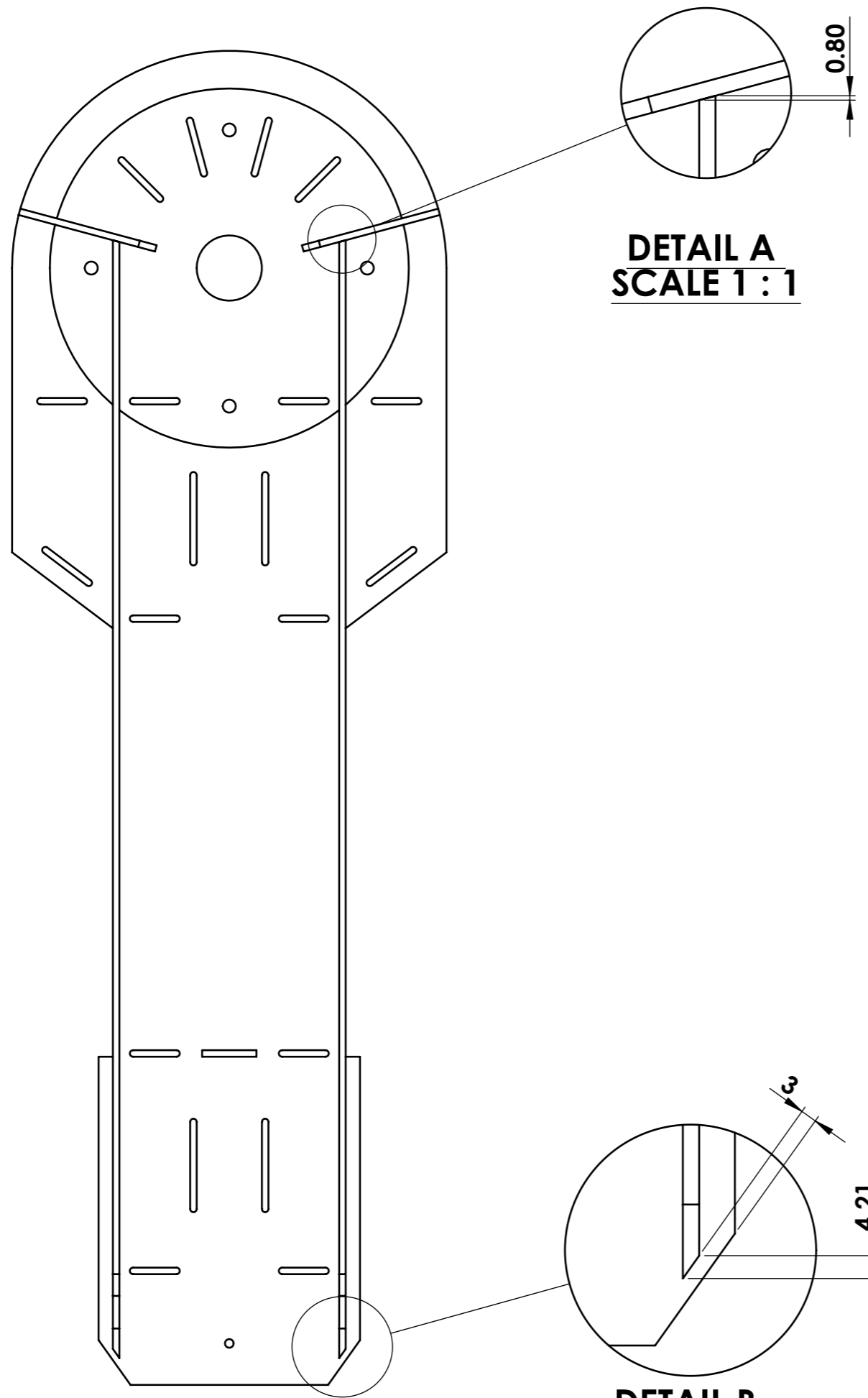

STEP 2

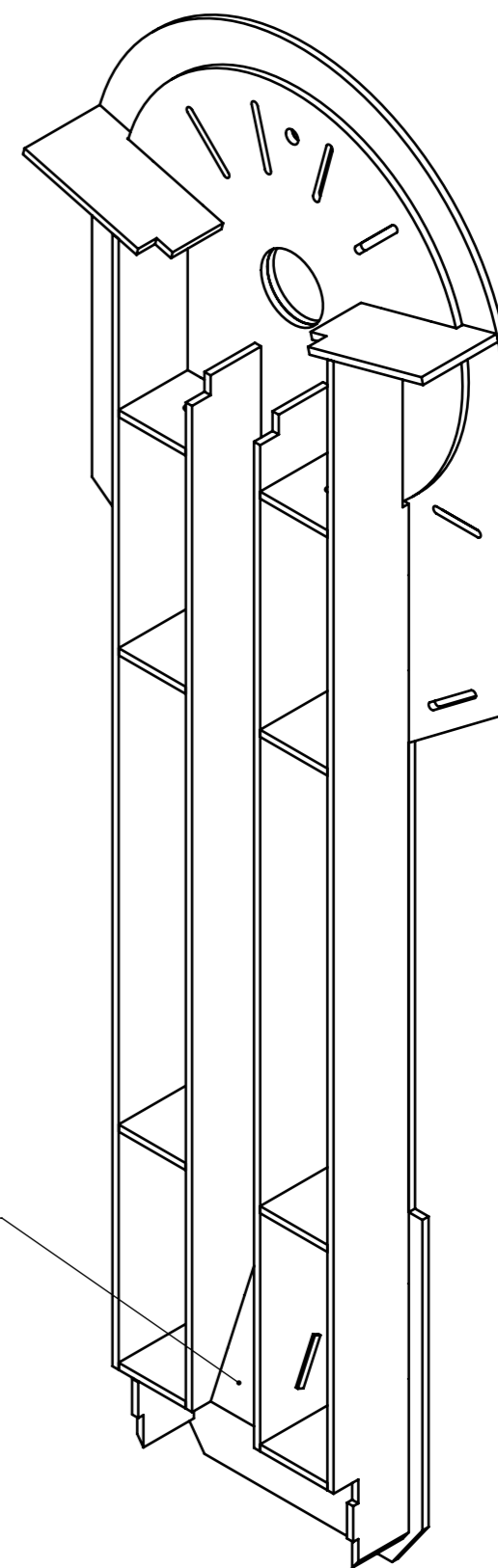
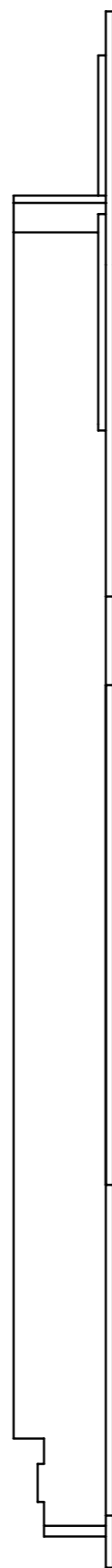
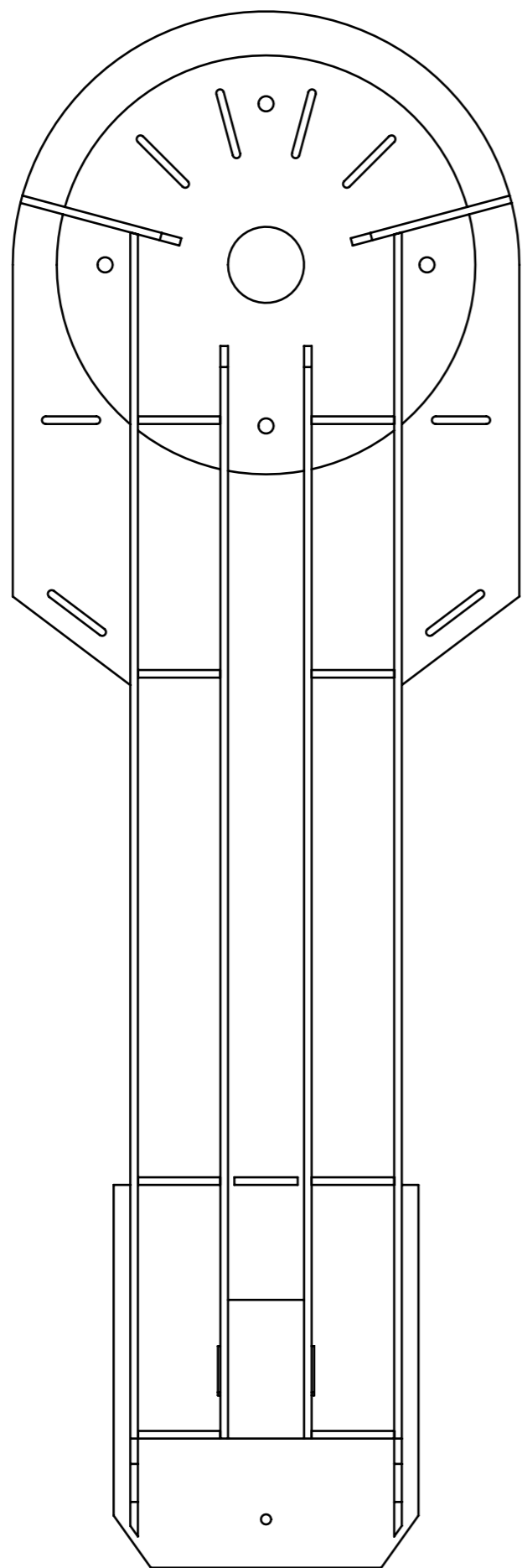

CABLE GUIDE SLOPE

STEP 3

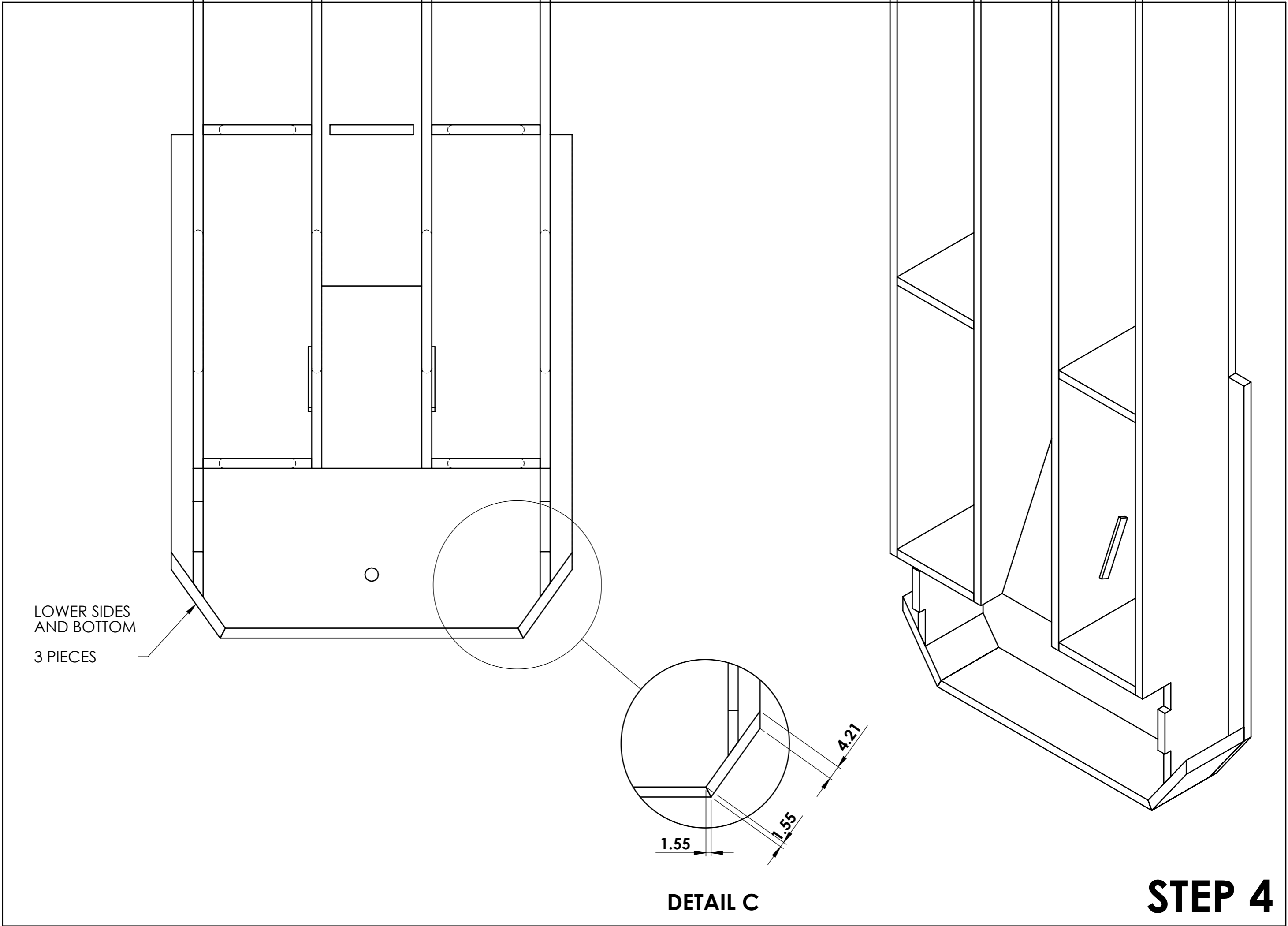

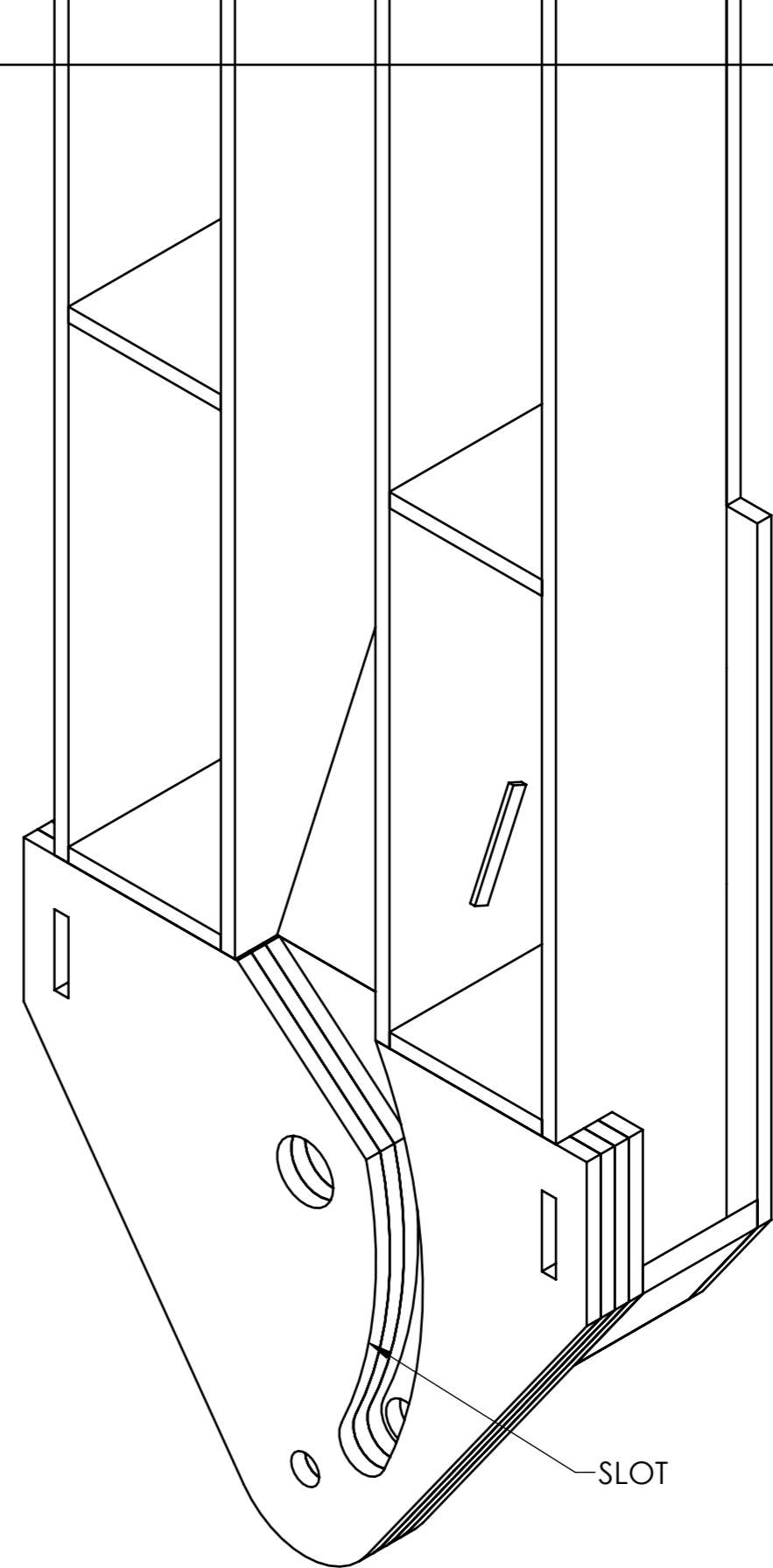
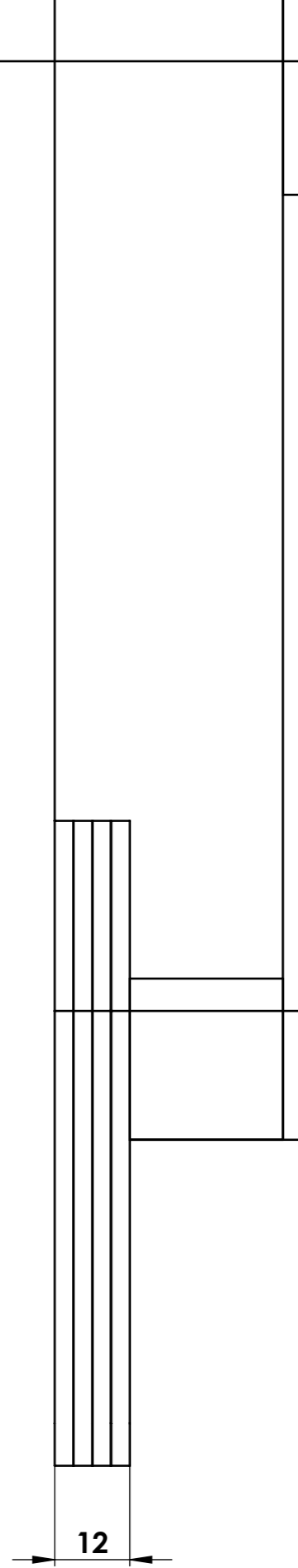

**RH LEG SHOWN
LH LEG, SLOT ON OTHER SIDE**

STEP 5

TOP SKINING RIBS

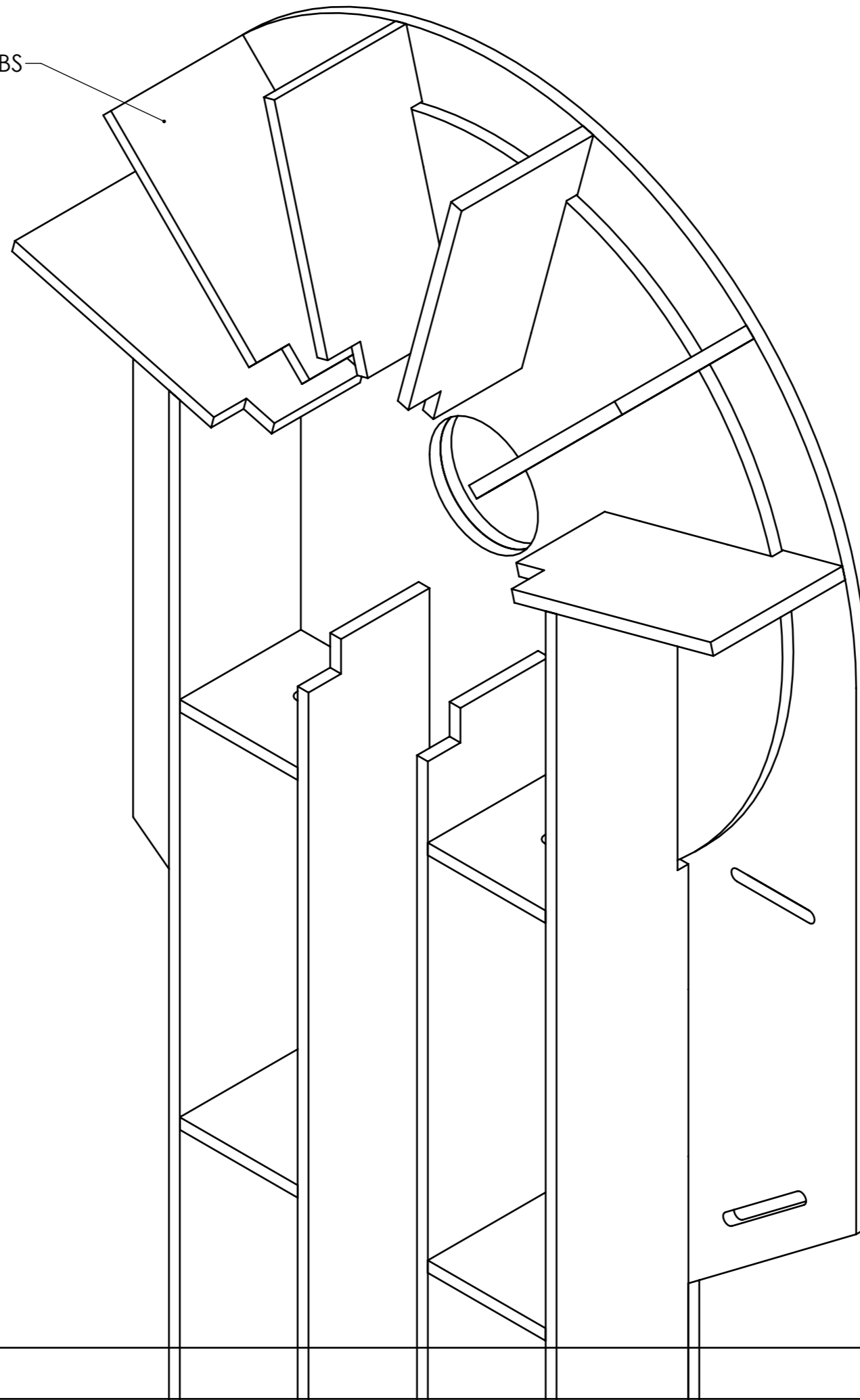

STEP 6

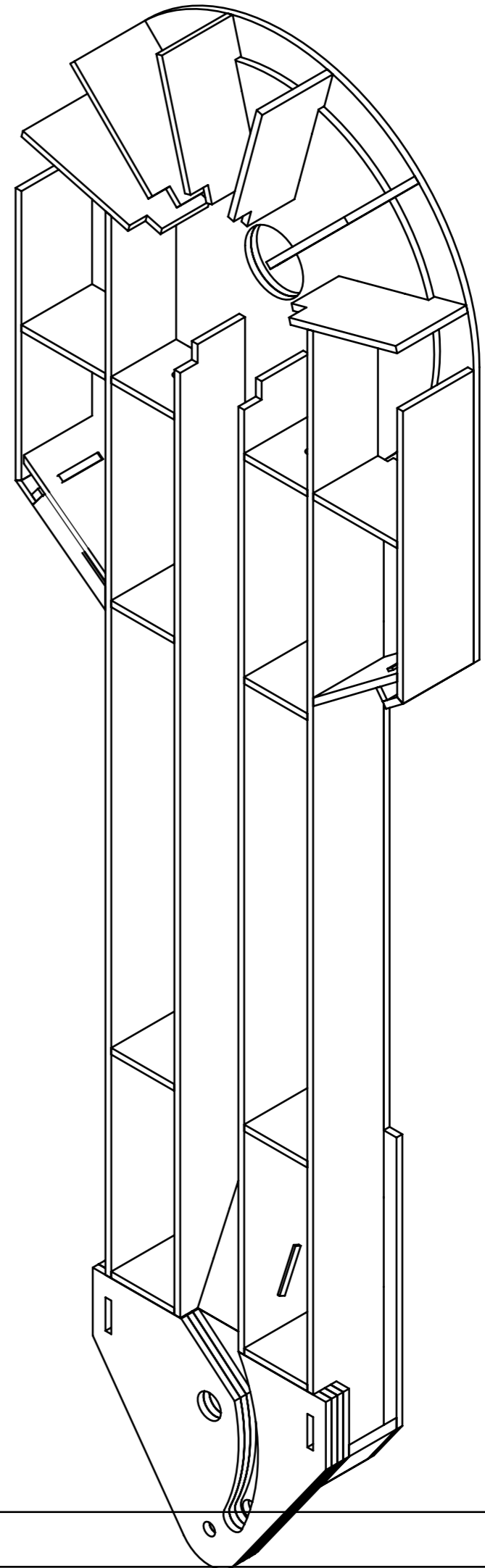
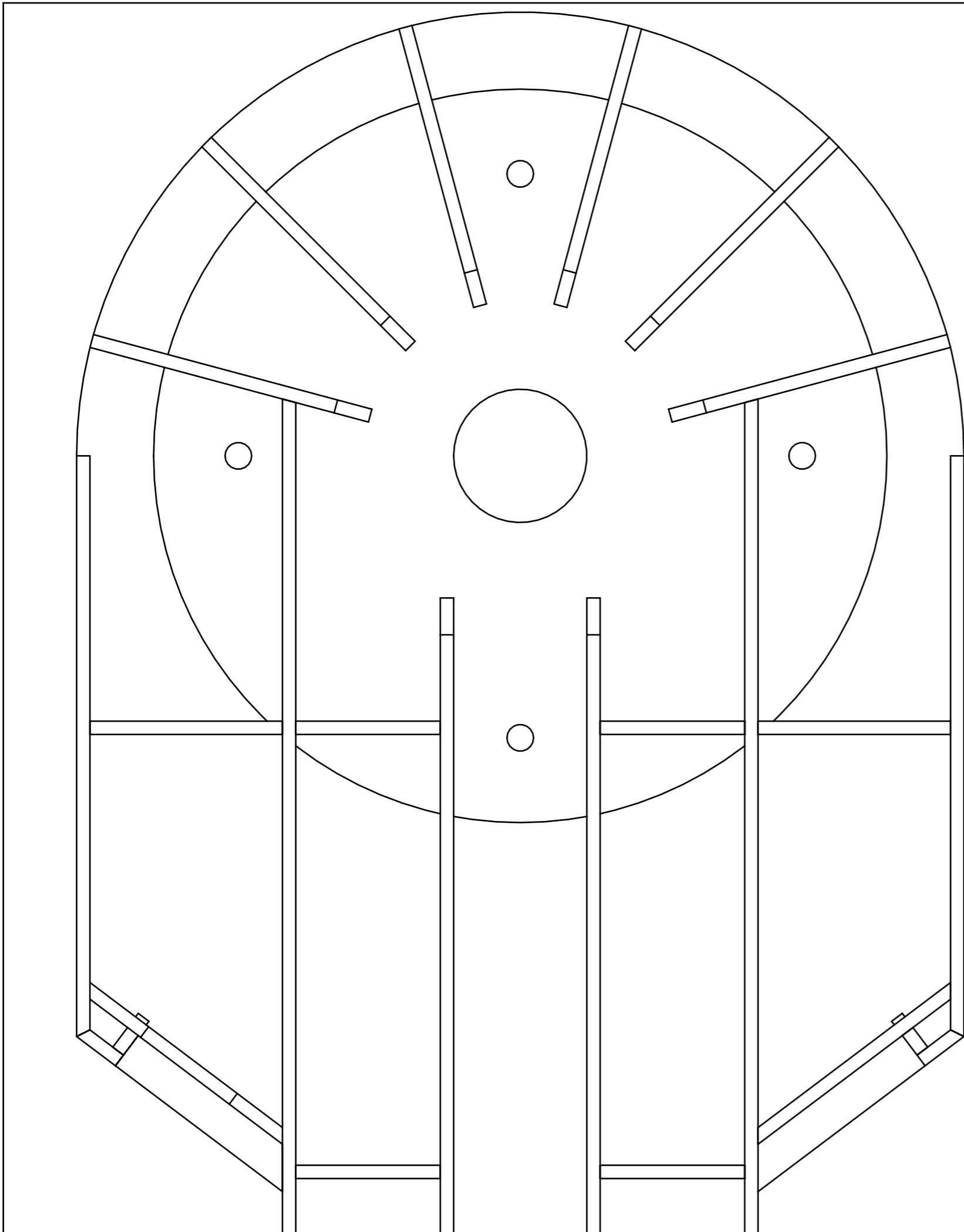

STEP 7

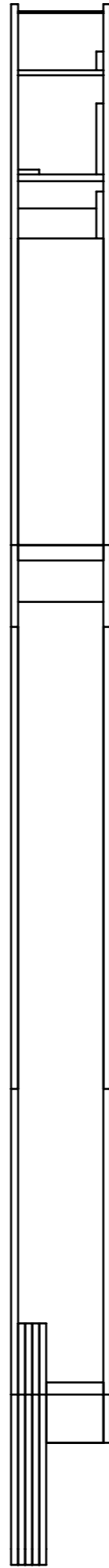
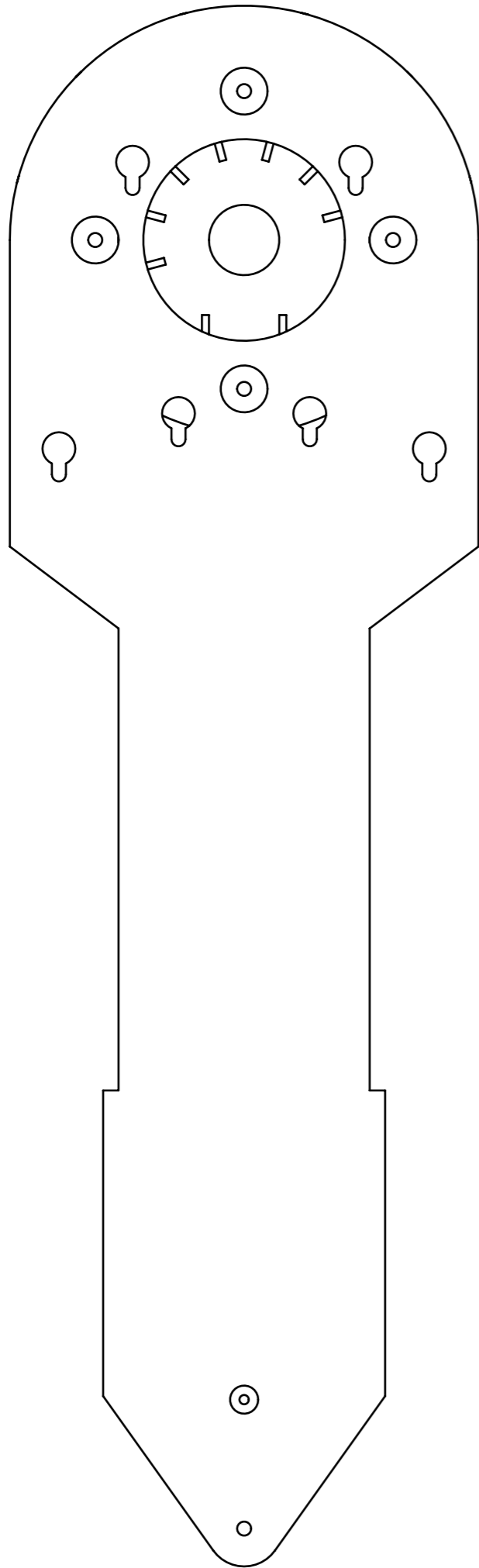

ADD FRONT COVER
AND DOUBLE CHECK FLATNESS
OF THIS SIDE

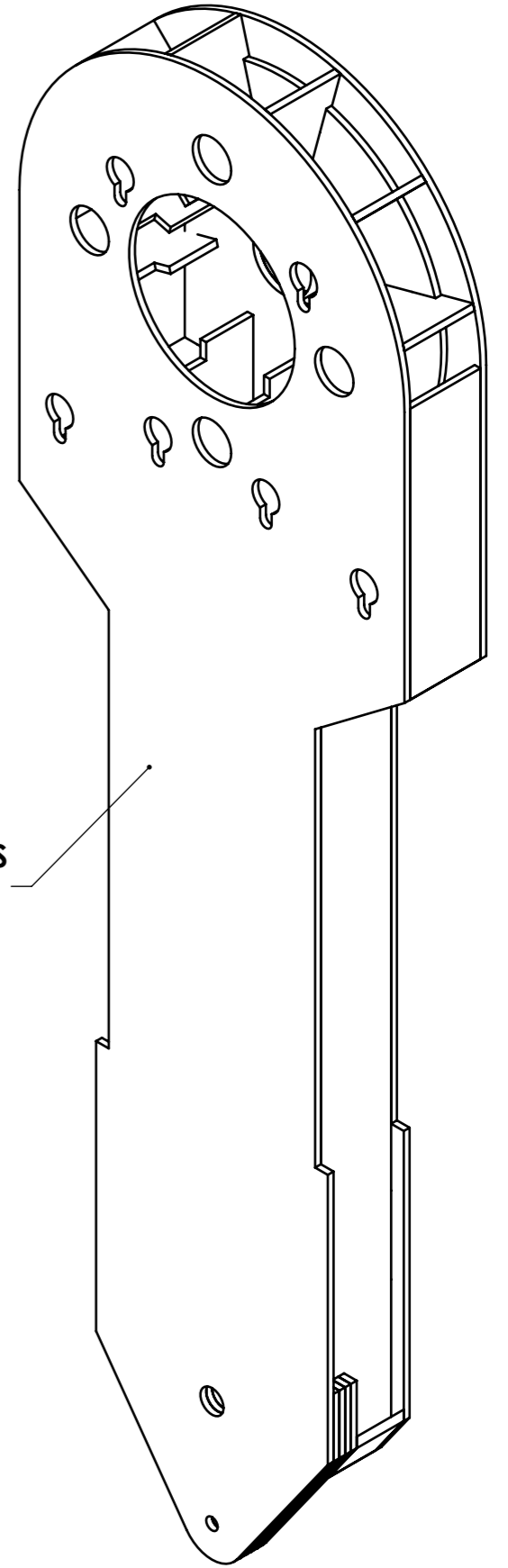

STEP 8

STEPS 9 TO 12
!! MAKE SURE IT IS MADE
ON A FLAT SURFACE !!!

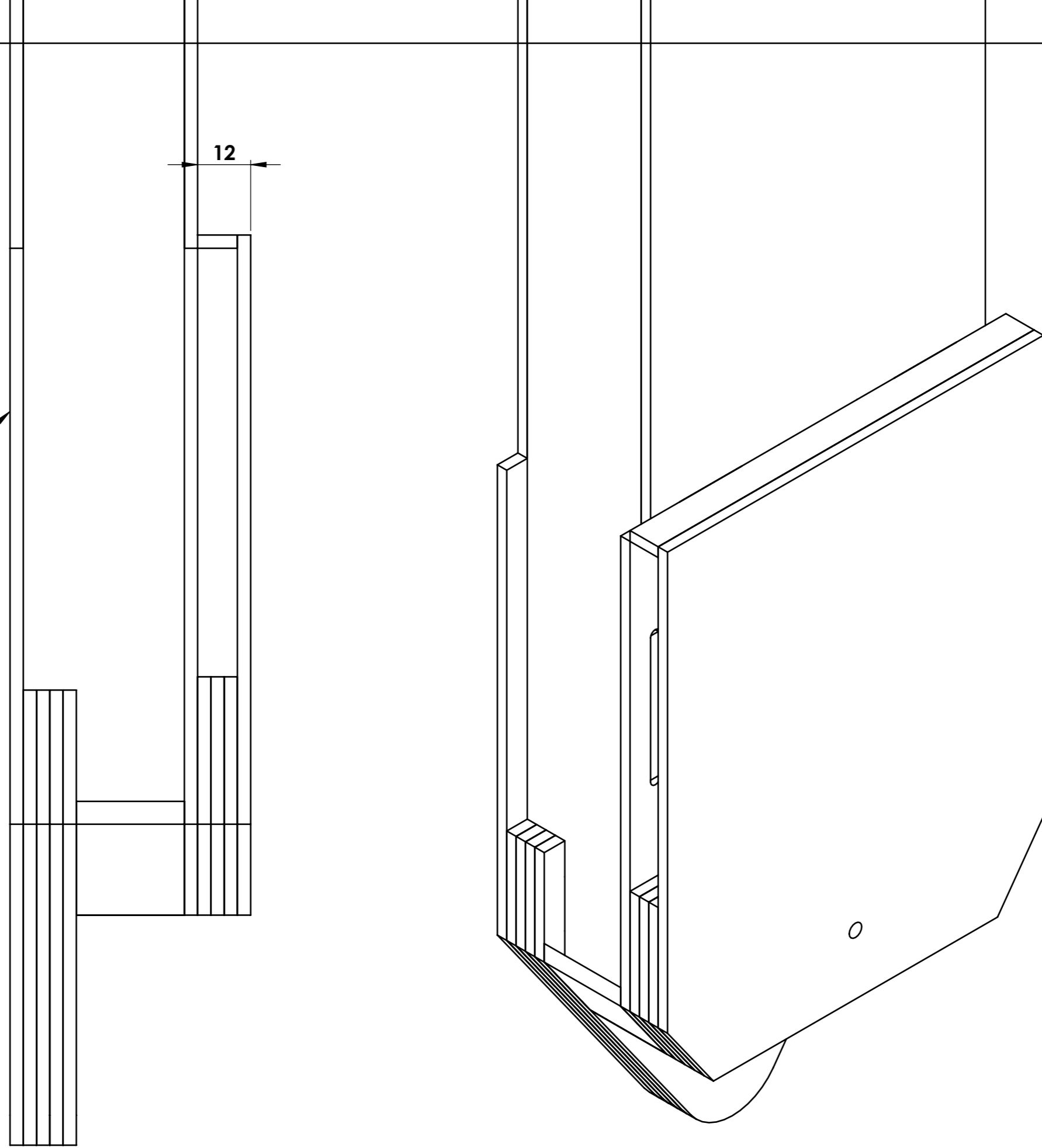

STEP 9

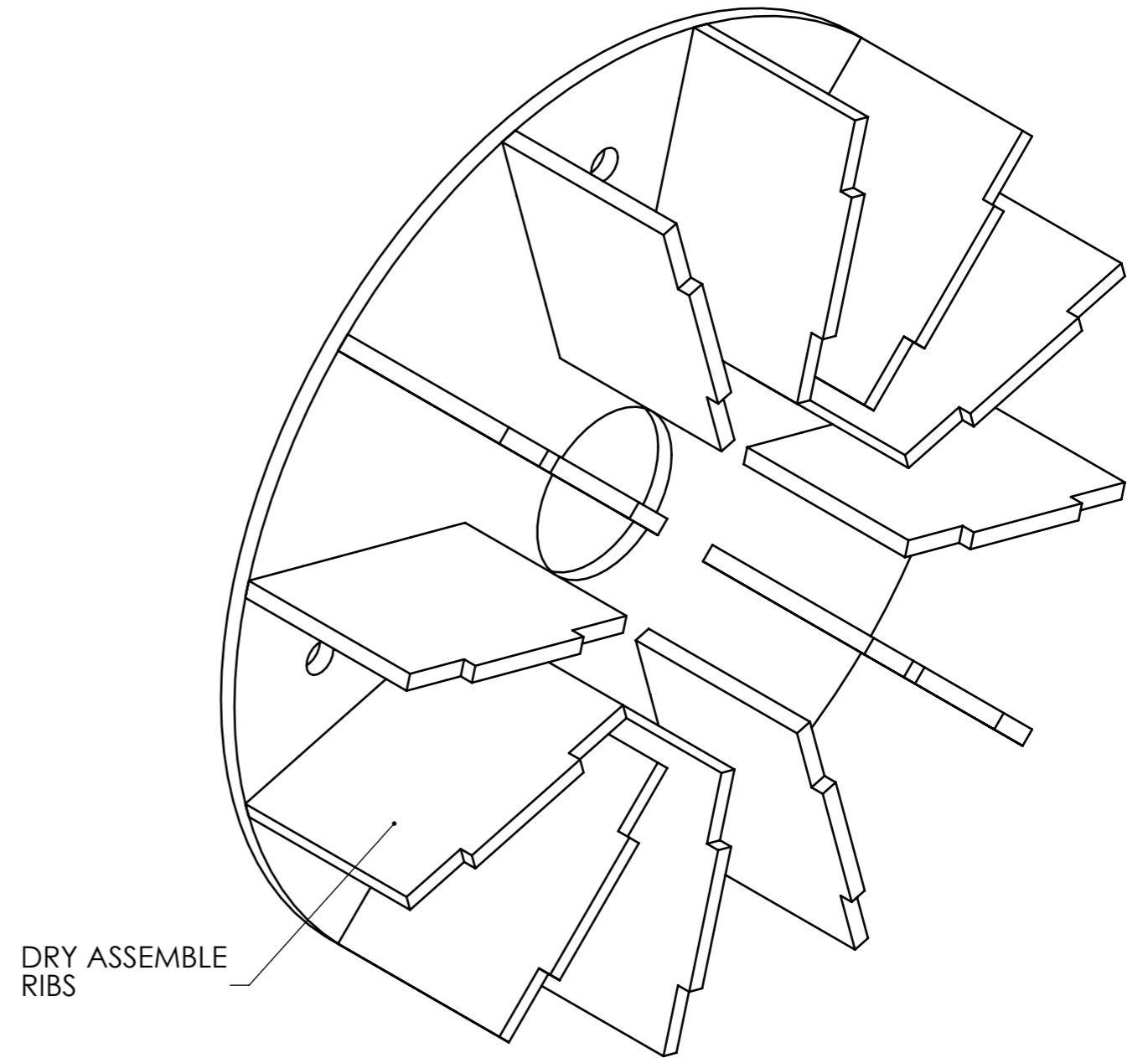
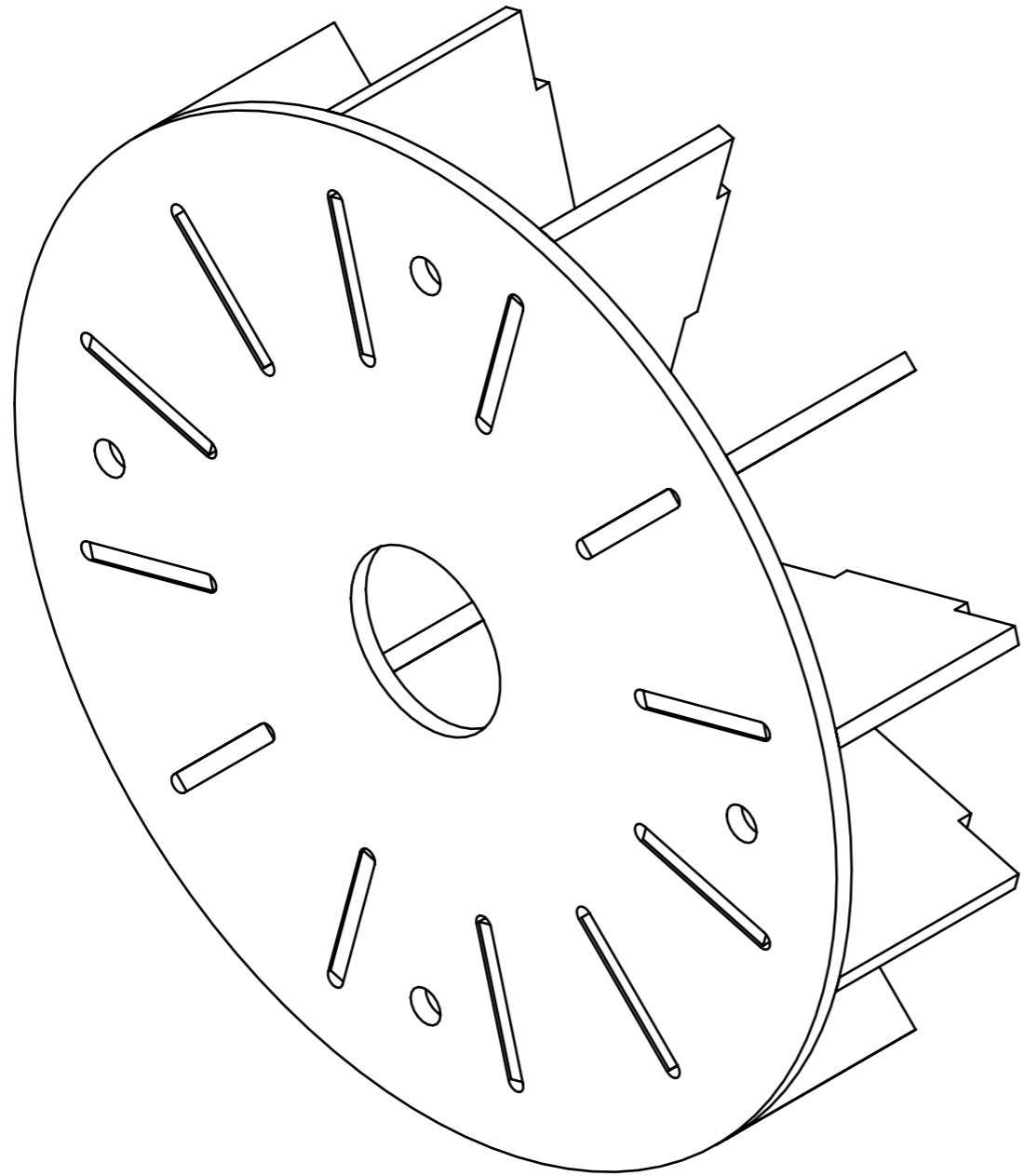

STEP 10

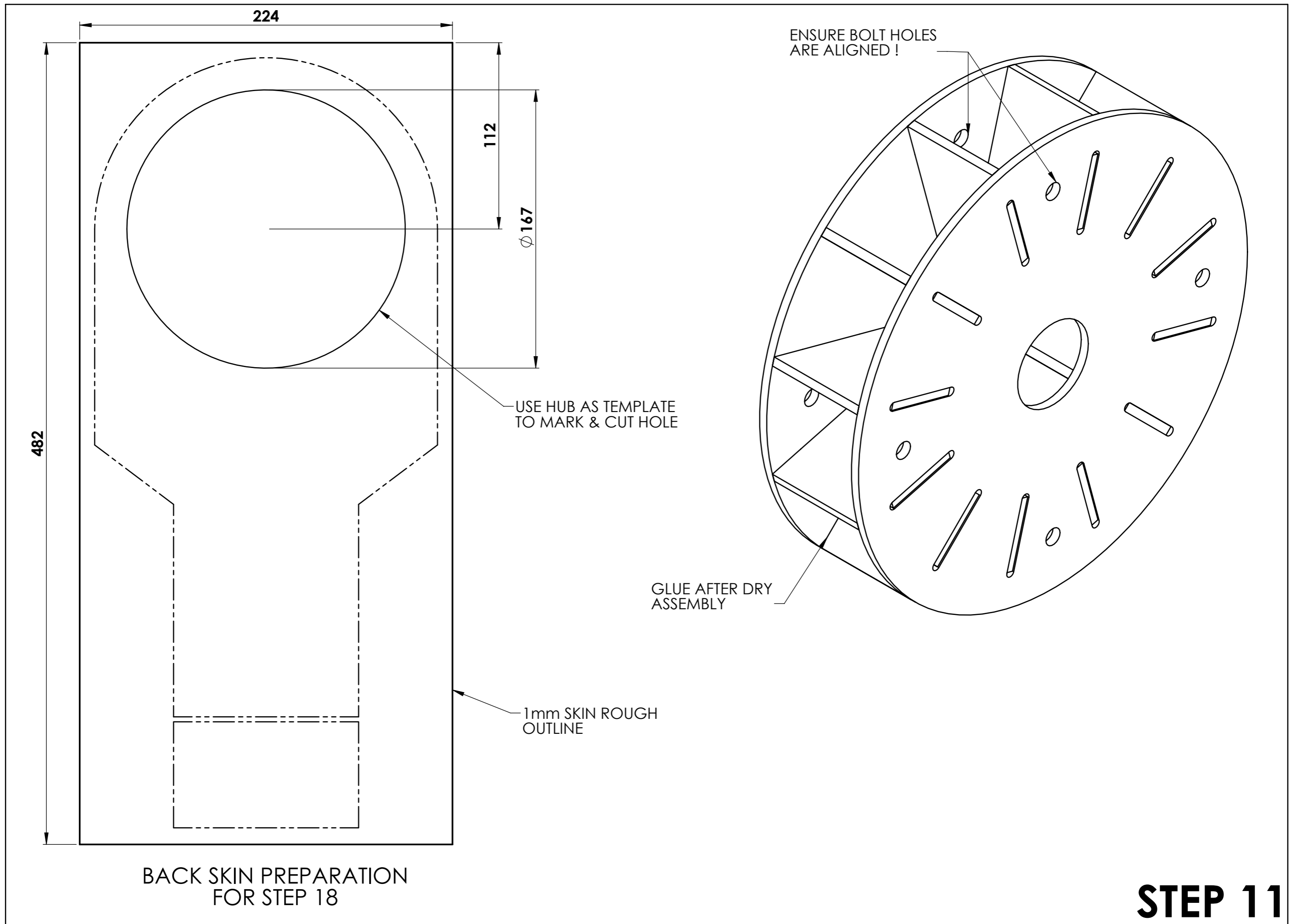

STEP 11

42

45

ADD OUTER COVER

ENSURE JOIN
THROUGHLY GLUED

STEP 12

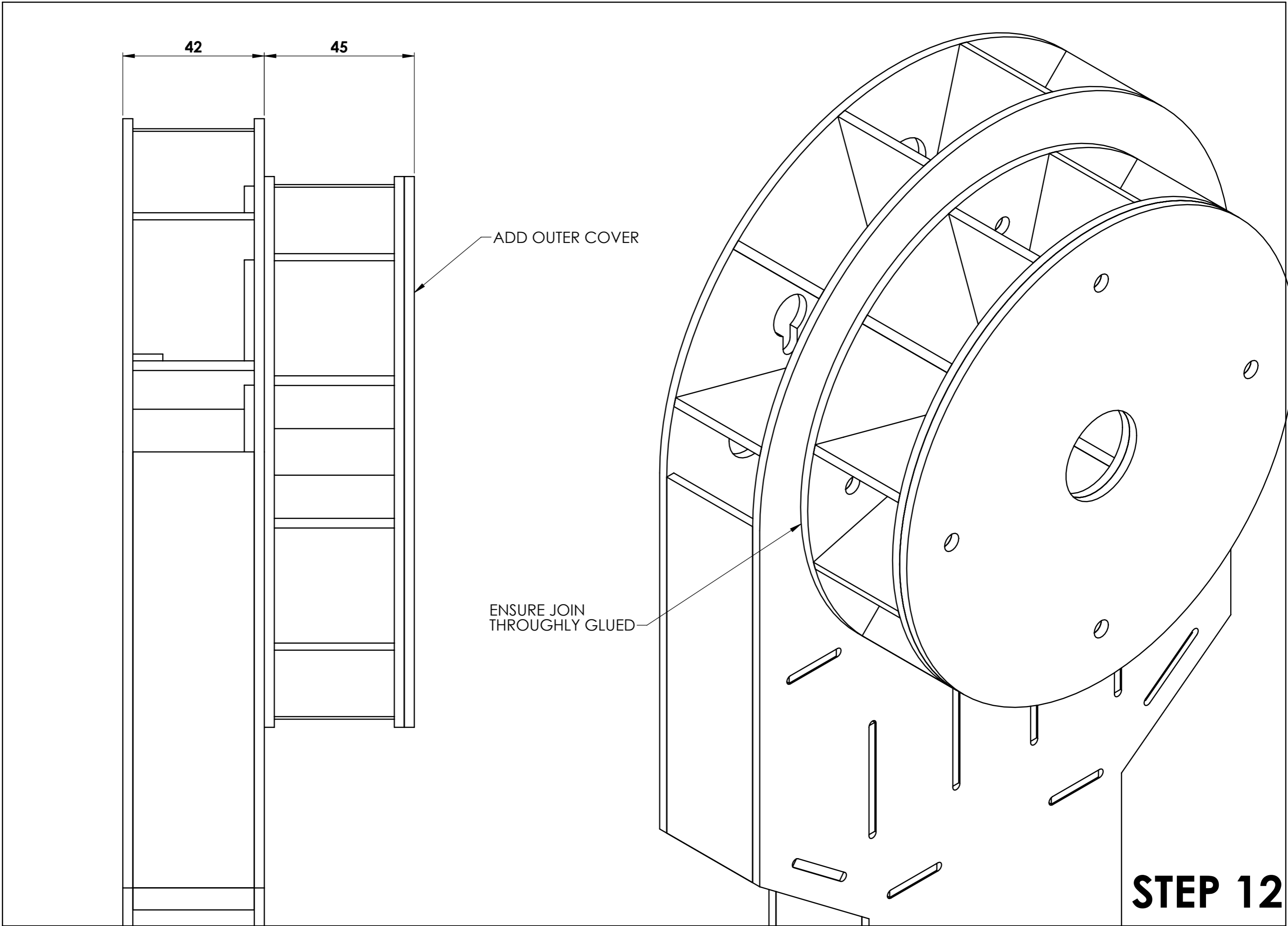

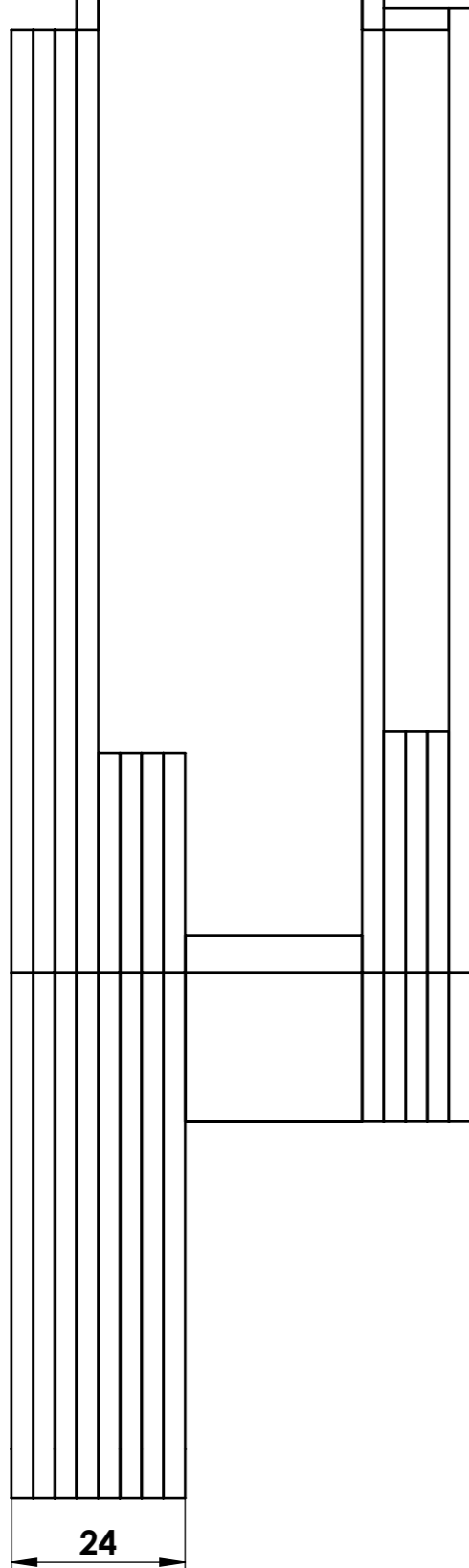

OUTER FACE A SOLID PIECE.
THE NEXT 2 PLATES HAVE LARGE
CUT-OUT IN THE CENTRE

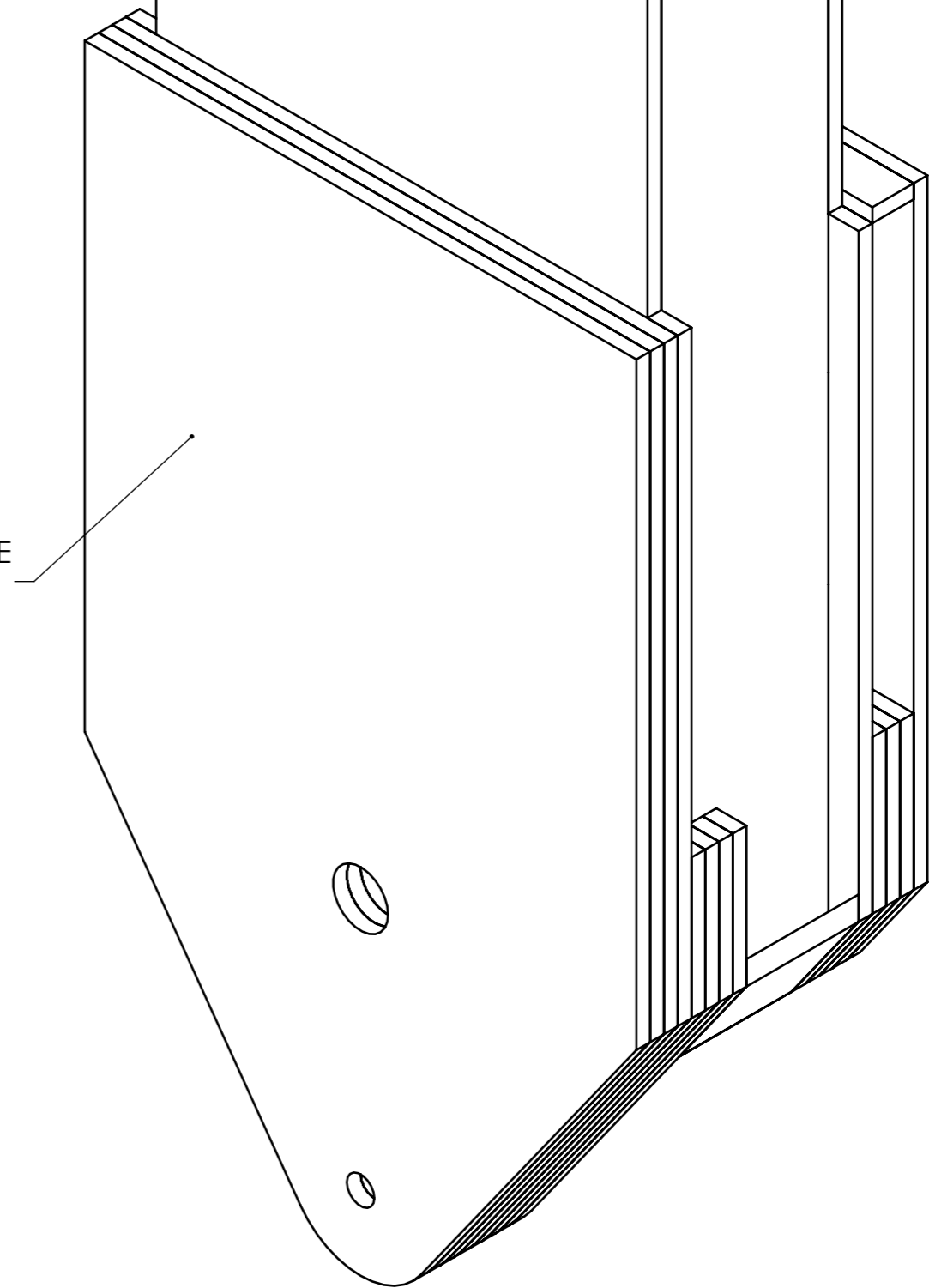

STEP 13

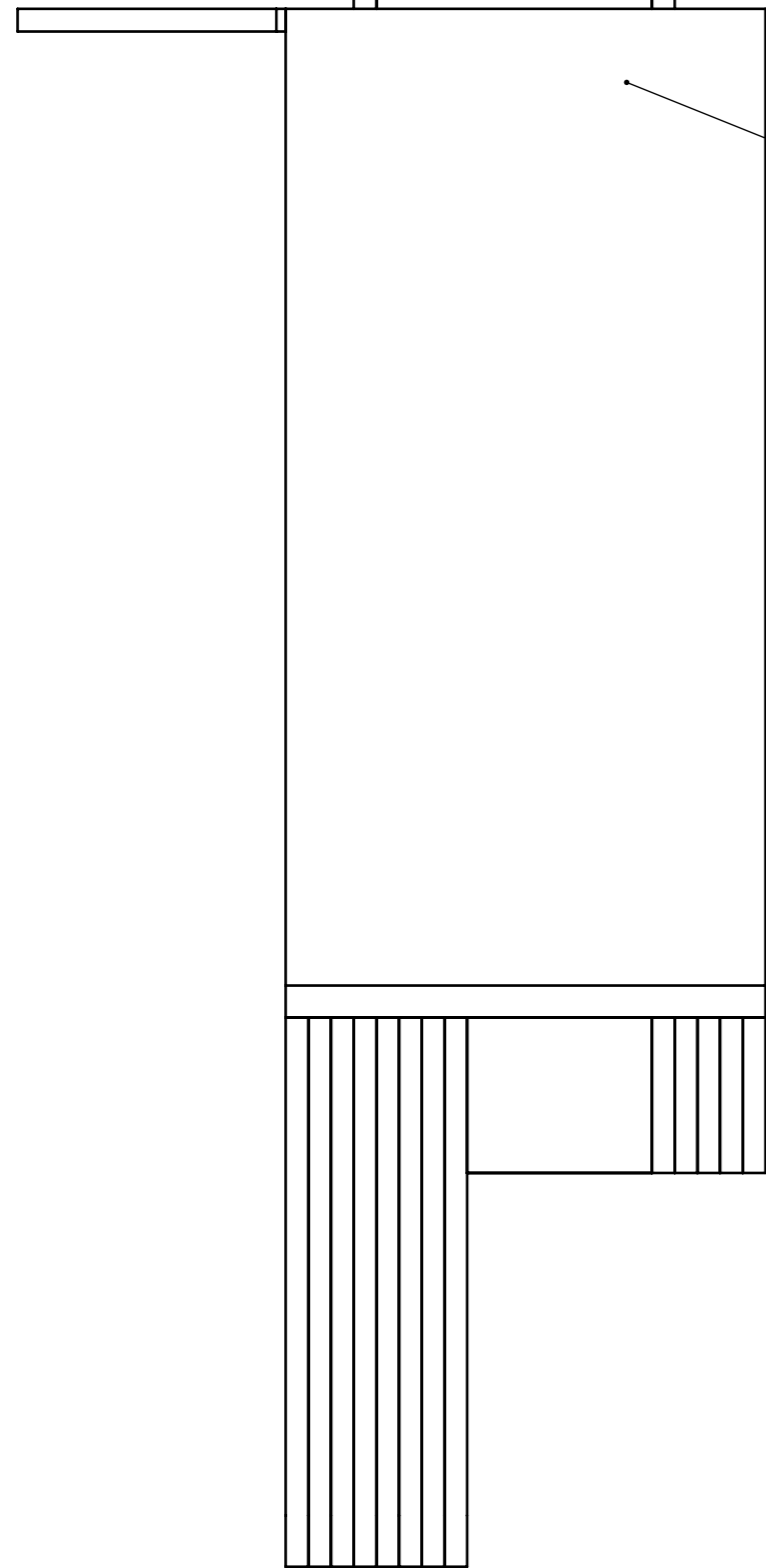

SIDE PLATES

SHAPE SIDES

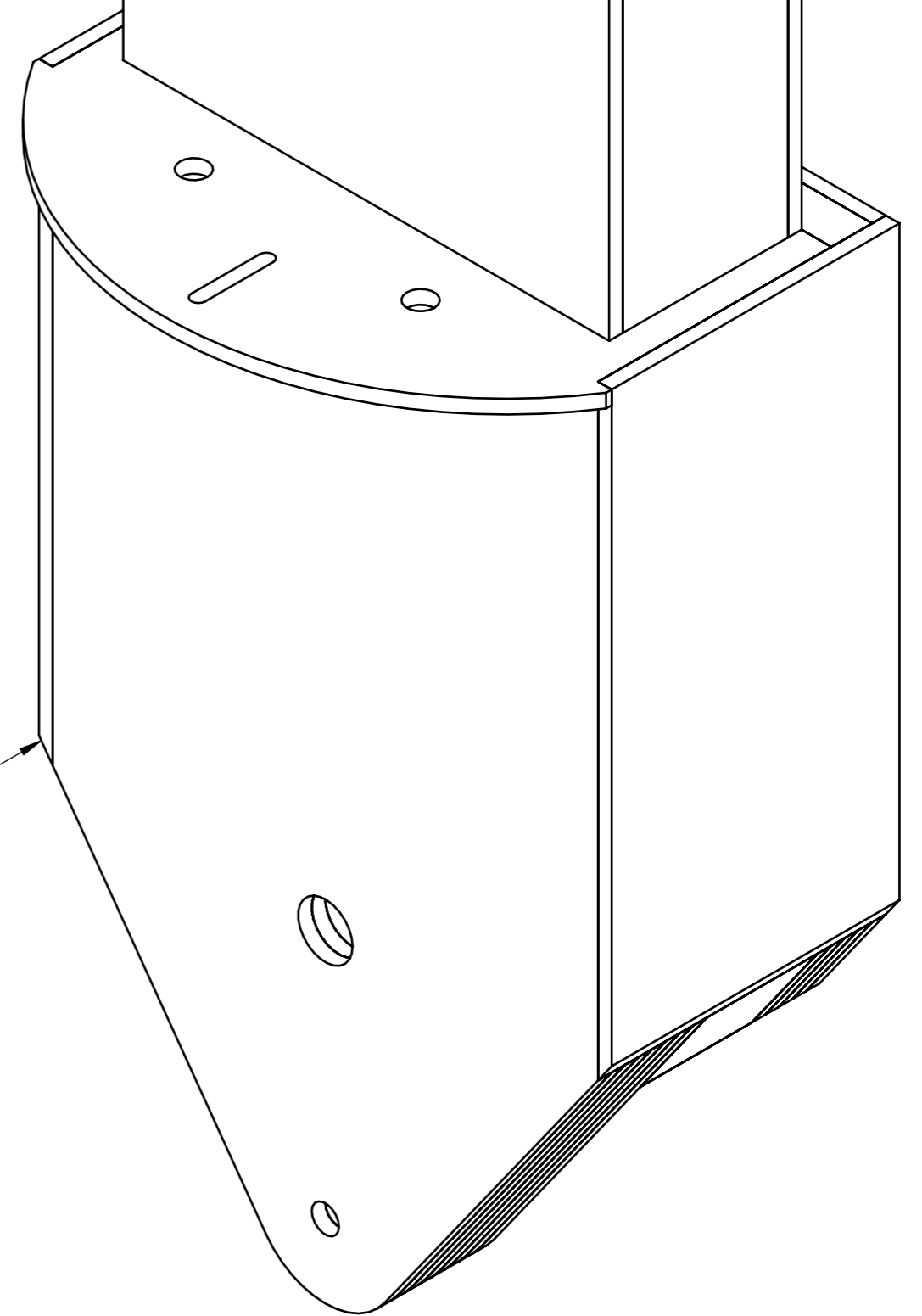

STEP 14

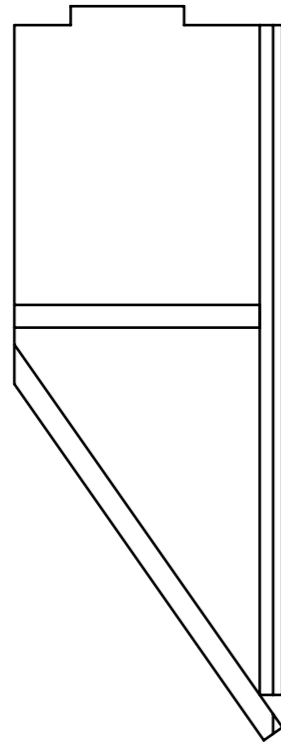

DONT SAND JUST YET

MAKE CUT-OUT
CORNERS SQUARE

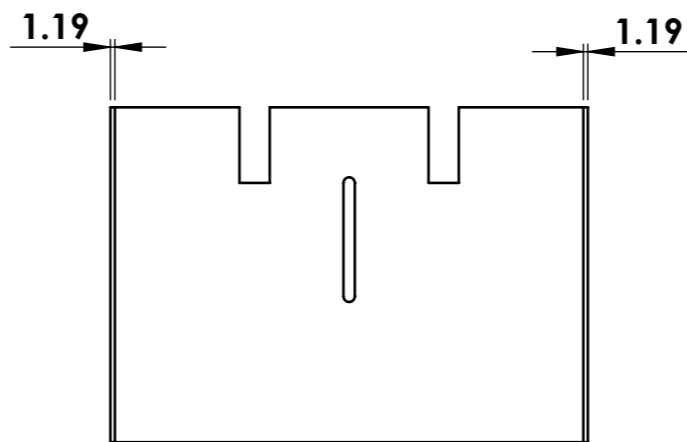
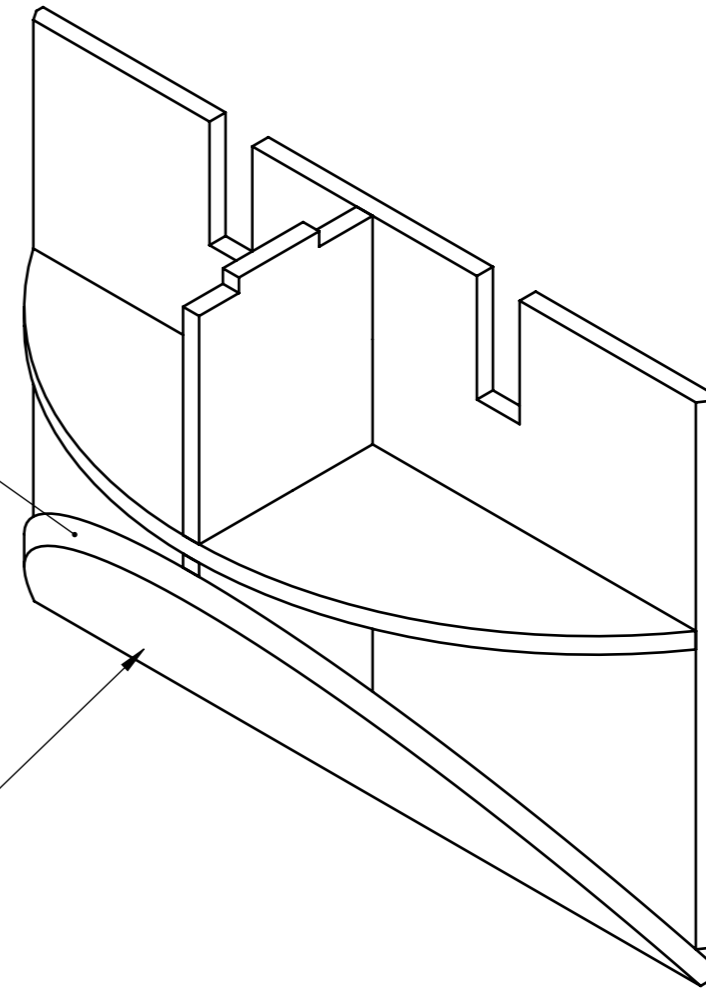

STEP 15

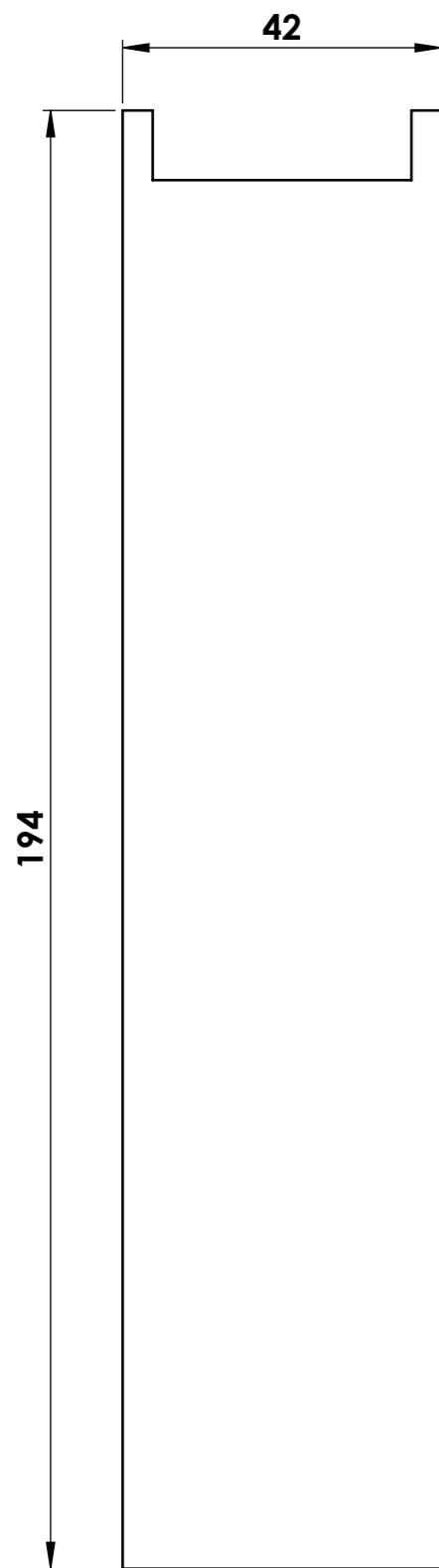

INNER SKIN
2off REQUIRED
(FULL SIZE)

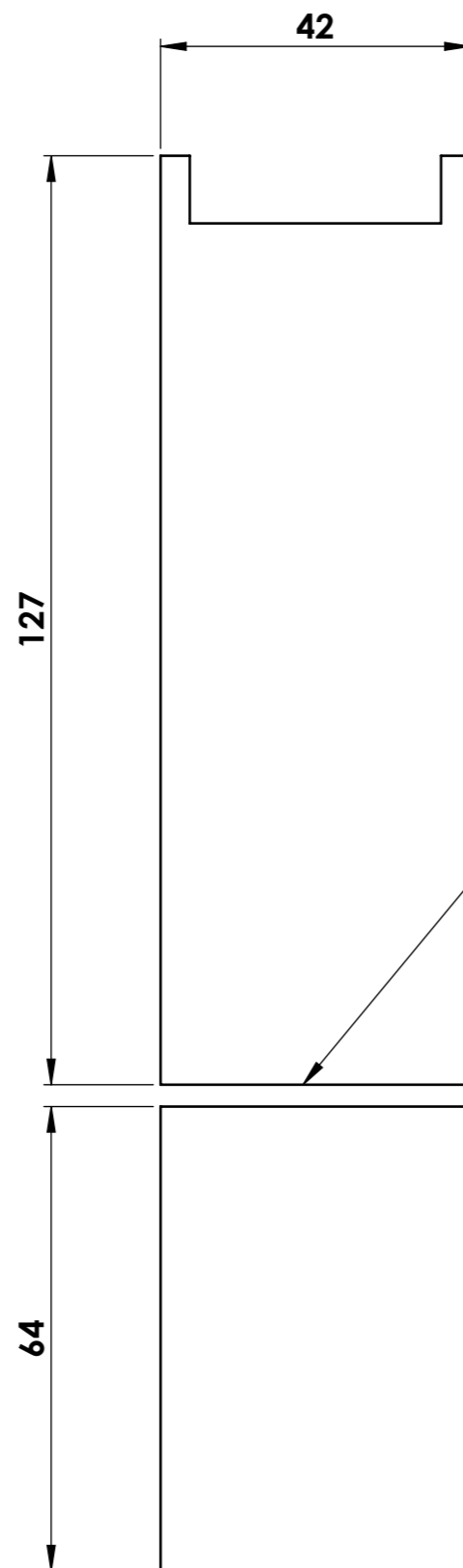

OUTER SKIN
2off REQUIRED
(FULL SIZE)

BEST NOT TO SKIN UNTIL
YOU HAVE MADE BOOSER COVERS
TO GET SLOT ALIGNED NICE

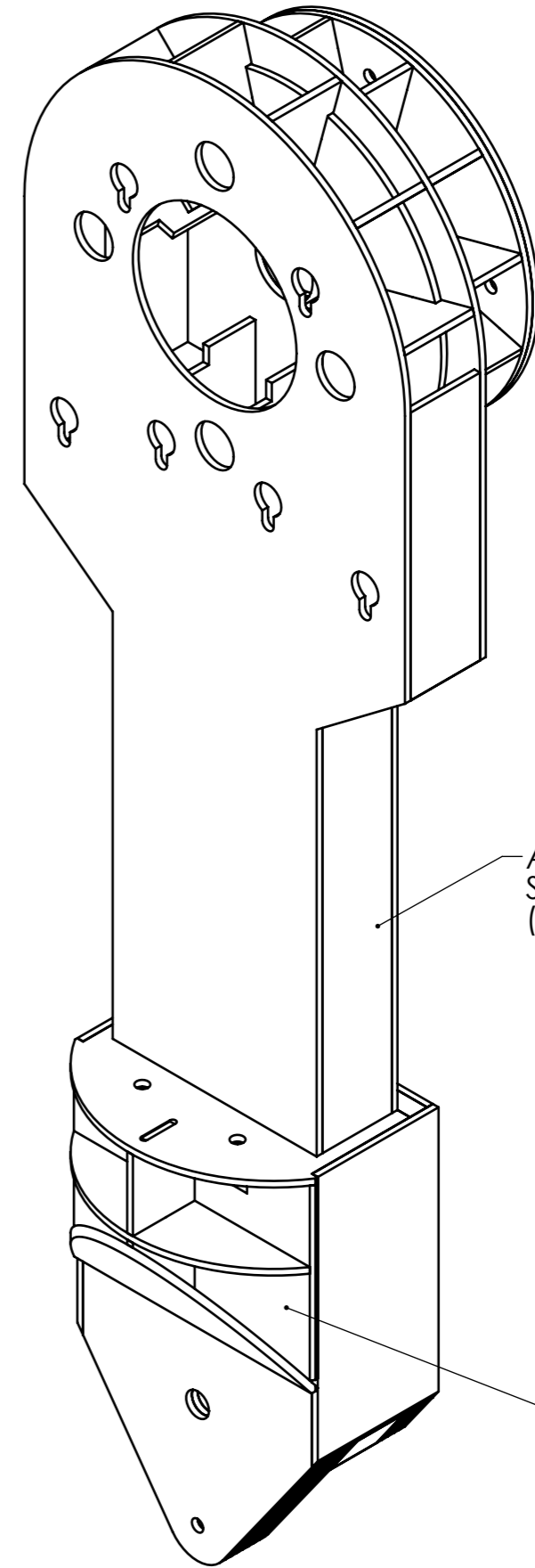

ADD INNER & OUTER
SIDE SKINS
(BOTH SIDES)

ADD ANKLE

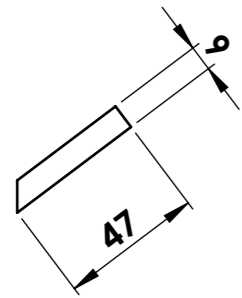

ARMPIT FILL
4off REQUIRED
(FULL SIZE)

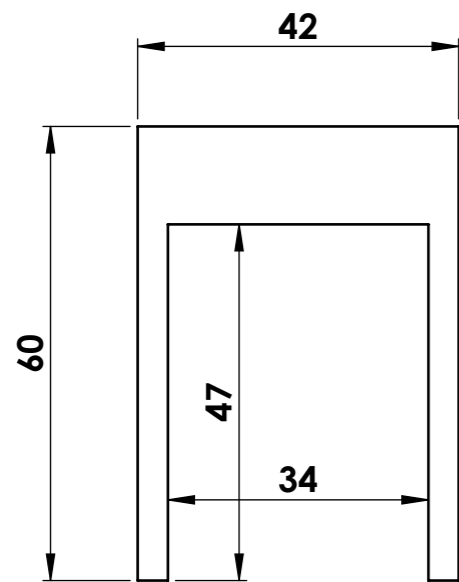

ARMPIT SKINS
2off REQUIRED
(FULL SIZE)

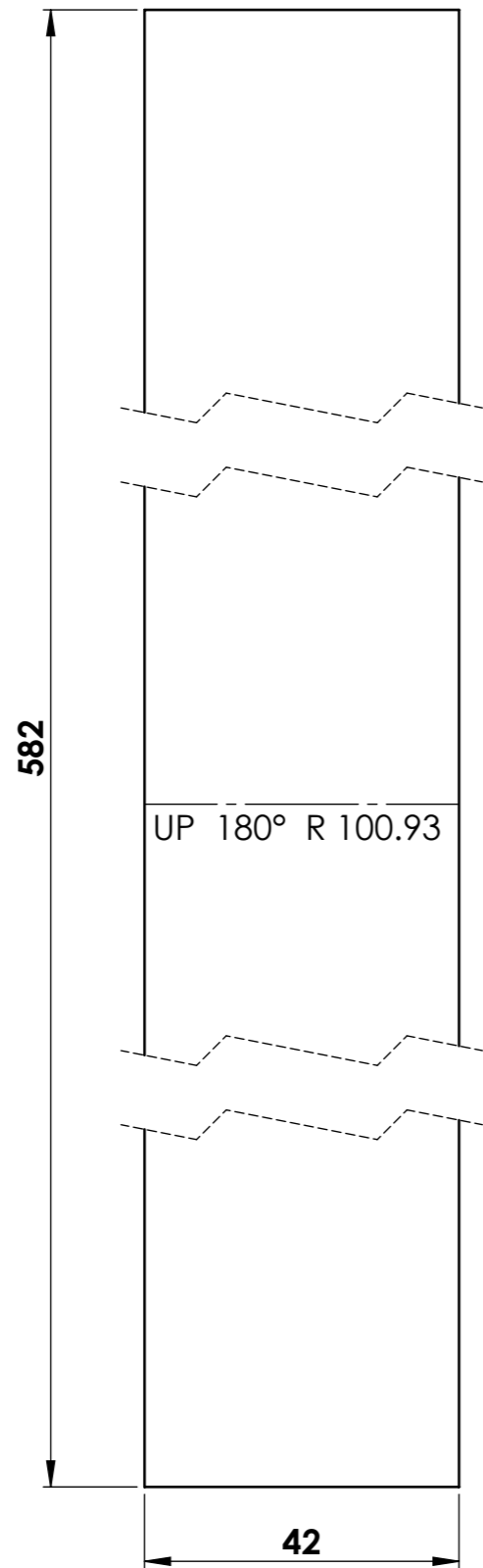

SHOULDER SKIN
2off REQUIRED
(LENGTH NOT TO SCALE)

FILE BACK ANGLE
BEFORE GLUING

1

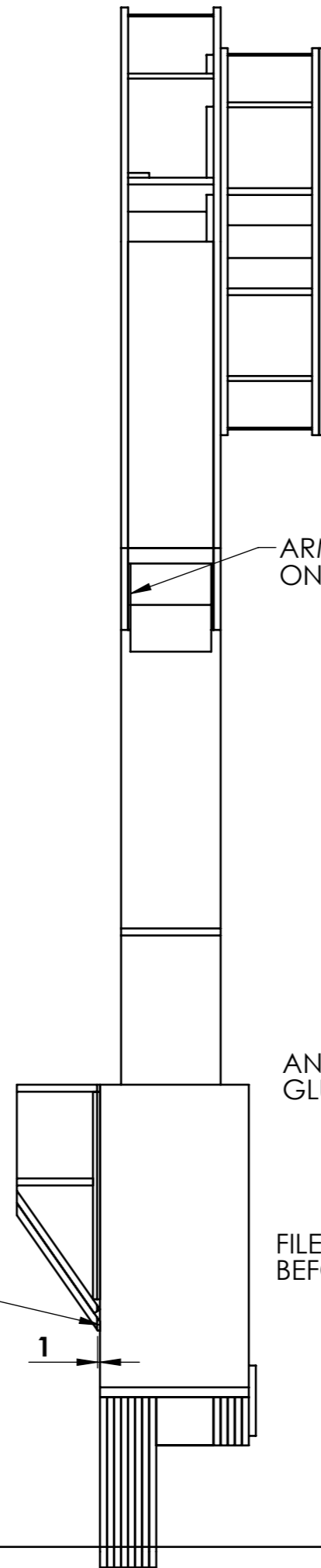

ARMPIT FILL
ON INSIDE FACE

AND CURVE ONCE
GLUE HAS SET

FILE HOLE SQUARE
BEFORE GLUING ON

2 LAYERS OF SKIN !

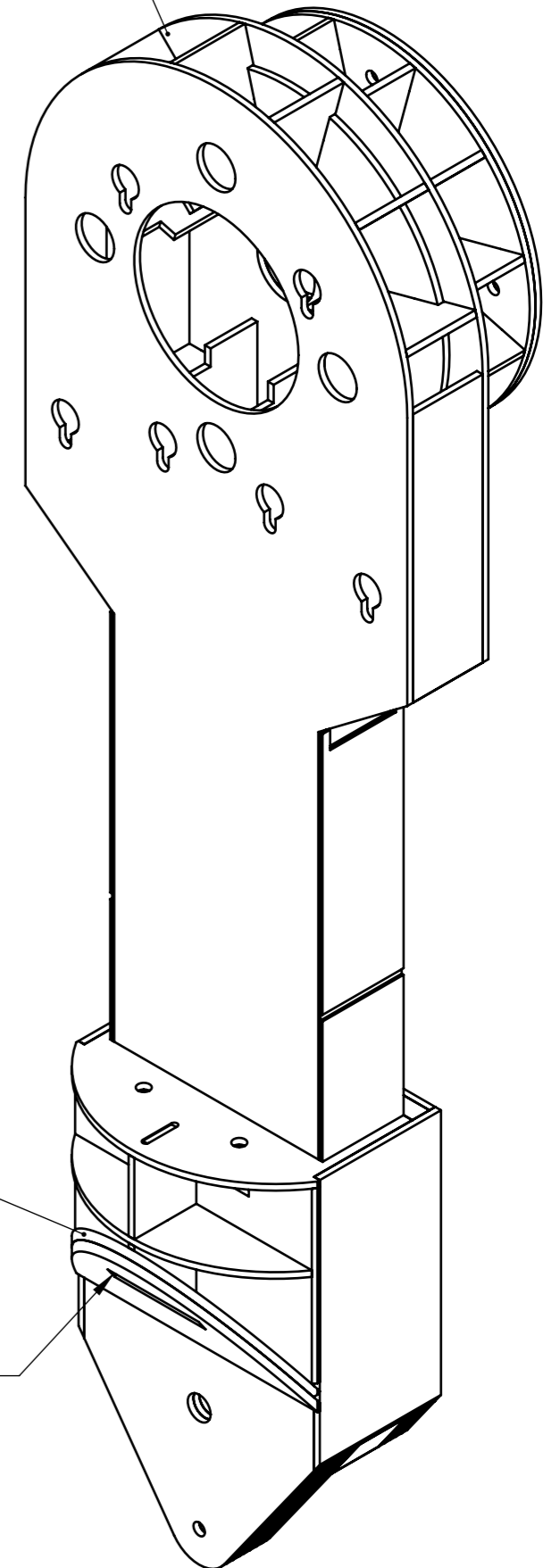

STEP 17

TIGHTEN FIRMLY NUT AND SCREW. THREAD LOCKER RECOMMENDED

USE FULL LENGTH THREADED SCREW OR THREADED ROD CUT-TO LENGTH (DEPENDING ON AVAILABILITY)

GENTLY TIGHTEN SO FLUSH WITH FRONT FACE. THREAD LOCKER RECOMMENDED

THICK, LARGE DIAMETER WASHERS UNDER NUTS AND SCREW HEAD

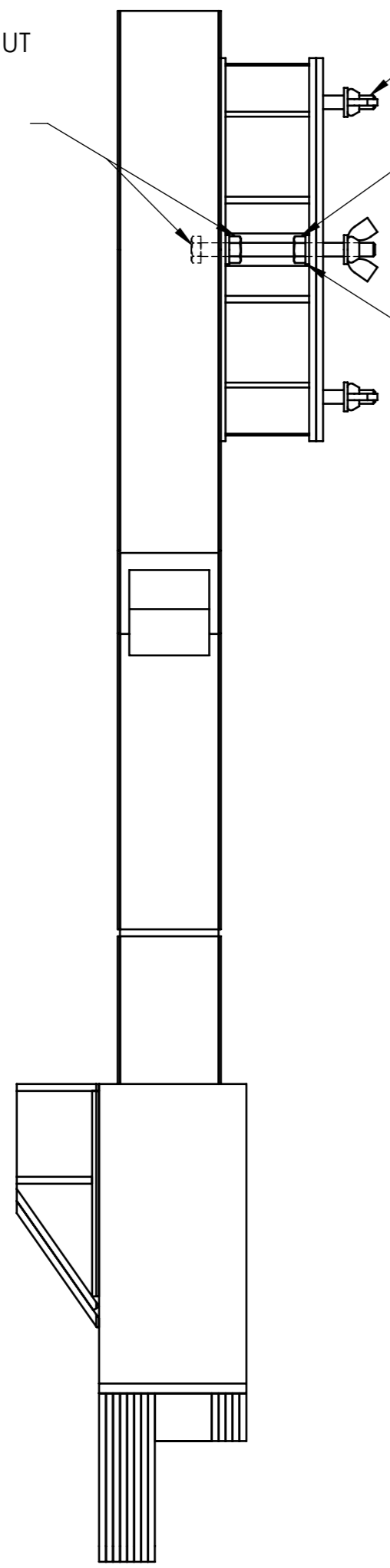

BEST NOT TO SKIN UNTIL YOU HAVE MADE BOOSER COVERS TO GET SLOT ALIGNED NICE

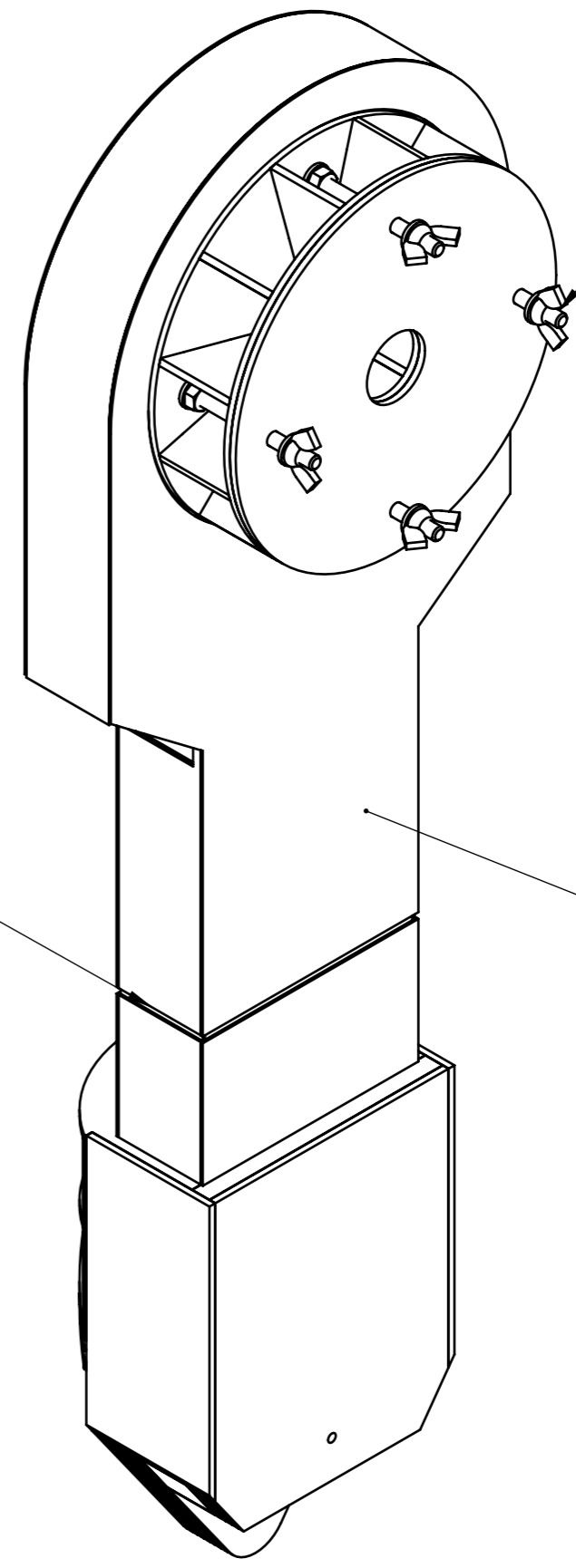

FIT FASTENERS

SKIN FRONT & BACK FACES

STEP 18

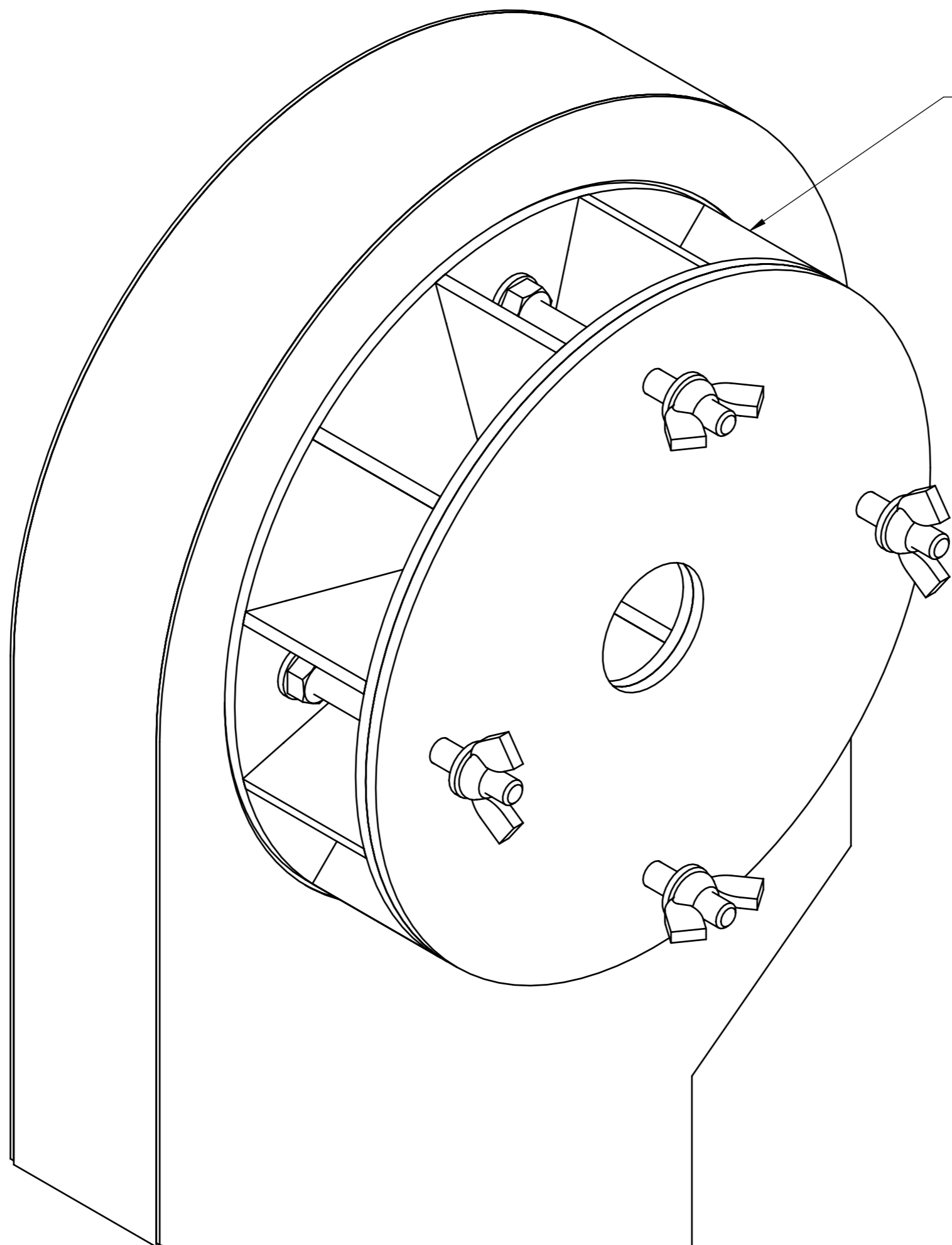

2 LAYERS OF 1mm SKIN OVER HUB

STEP 19

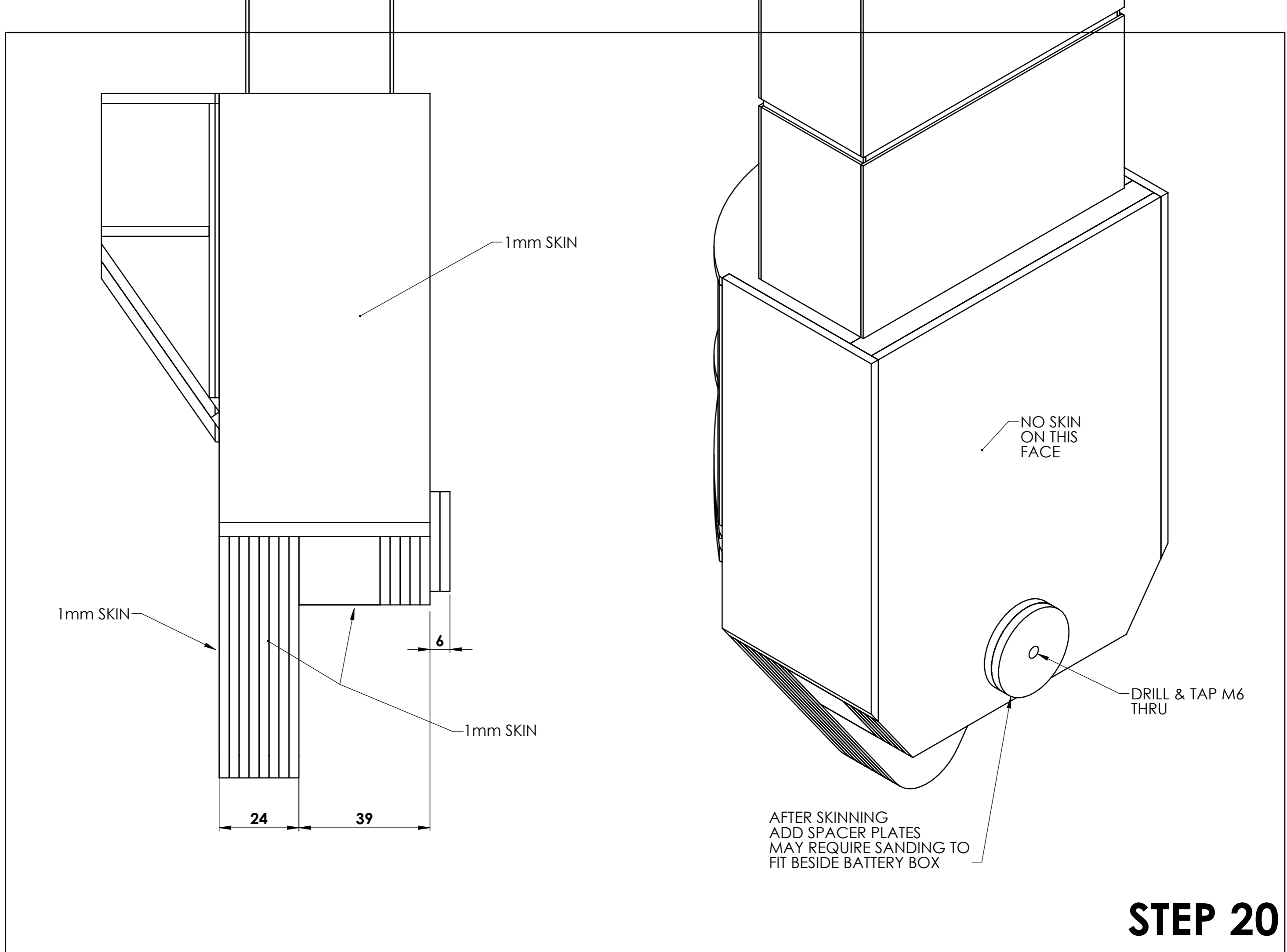

RECOMMEND TO CUT 5mm BIGGER
AND TRIM BACK AFTER
GLUE HAS CURED

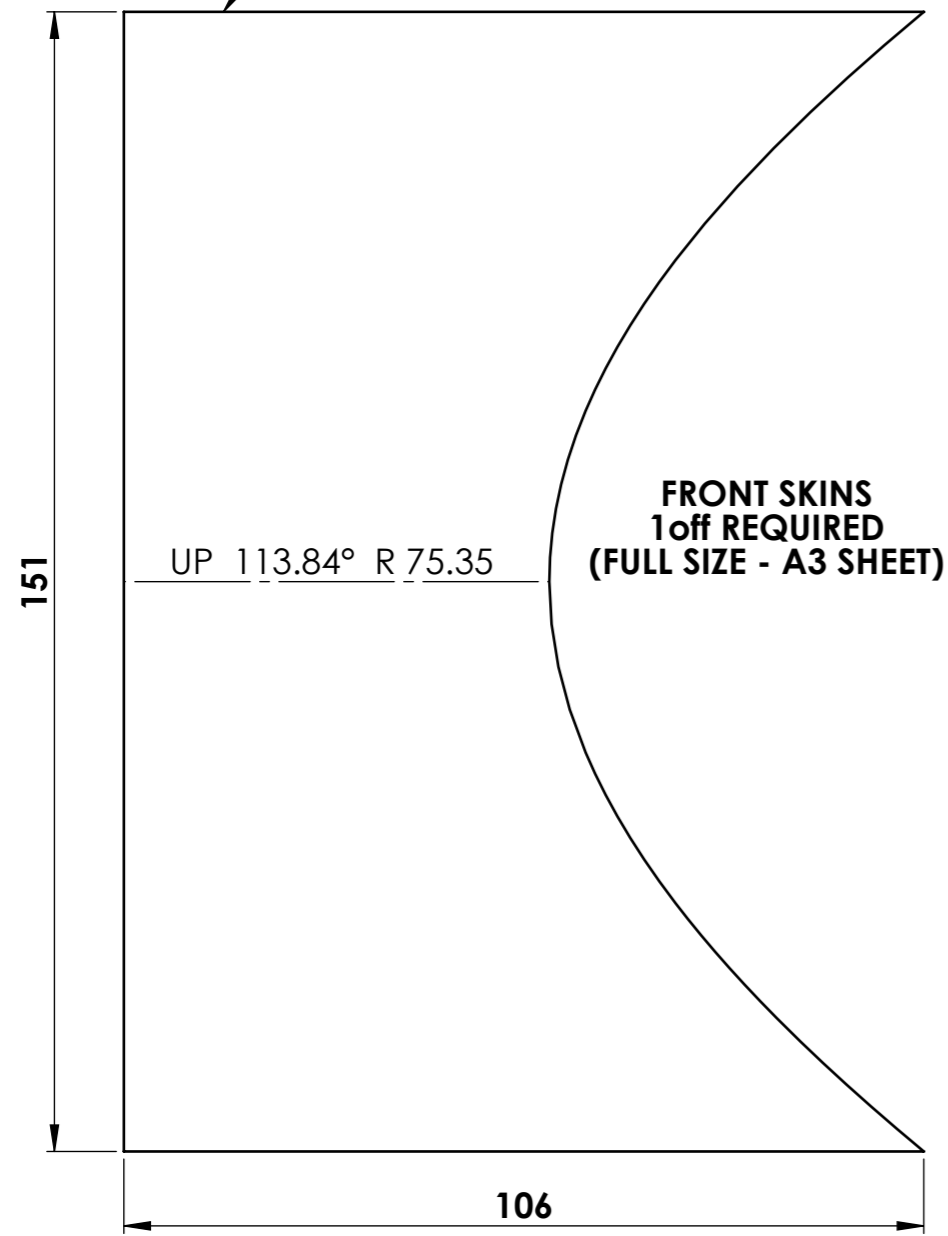

DRILL TO SUITE:-
DIA TO SUITE ALUMINIUM OR BRASS TUBE
WITH $\phi 8$ INSIDE FROM HARDWARE STORE
OR HOBBY SHOP (TYPICALLY $\phi 9$)
CUT TUBE TO LENGTH TO MAKE BUSH, AND GLUE INTO POSITION

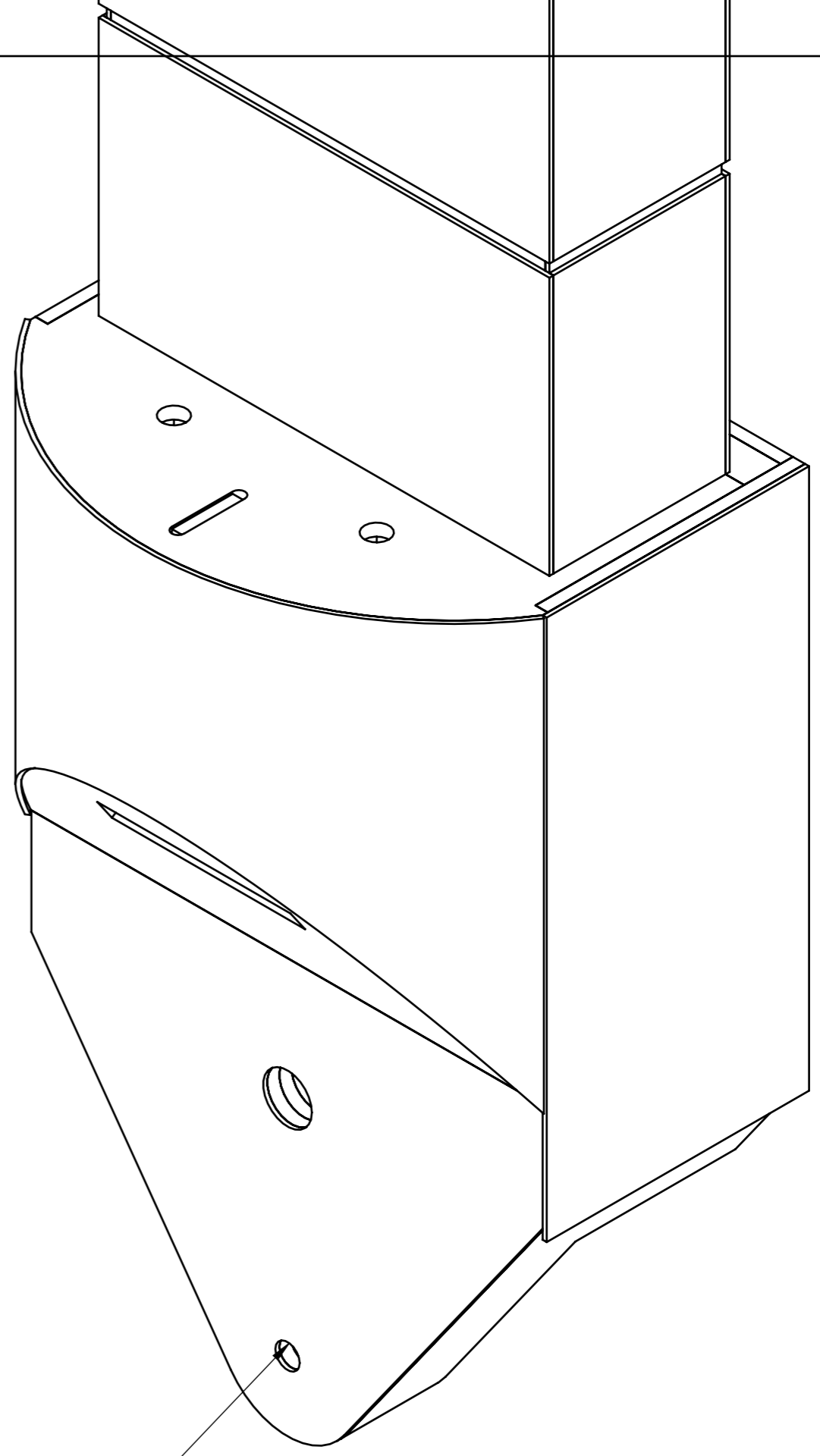

STEP 22